



□

□|□□□□□□□□|□□□□□□R□□

□□□□R□□□D□□□M□□□□□

□□R□

□□MM□□|□□R□□R□□□□|□□□□|□DI□□D□M□□|□□□□

M□R□□□□□□□□□□

□R□□□R□D□□□□□□□

□|□□□□□□□□|□□□□□□R□□

NOT FOR BID

NOT FOR BID

D R I M R I D
I I I I I I I I I I R
M R

R I M M I R R I I D I D M I I

This project consists of the demolition of the Community Recreation Building, located at 320 East Wildwood Avenue in Villa Park, Illinois. The scope of work includes the demolition, removal, and offsite disposal of the structures, mechanical equipment, foundation walls, slabs, footings, pavement, playground, basketball courts, light poles, and other appurtenances; backfilling of all building excavations with clean fill; and other related and incidental work.

I D D D I I R I M I M

The Village reserves the right to extend the Bid Deadline from this date and time to accept Bids submitted after the Bid Deadline, as the Village, in its sole discretion, determines is in the best interest of the Village.

R I D M I I R I M I M

An optional pre-bid meeting for potential bidders will be held at the Community Recreation Building, located at 320 East Wildwood Avenue in Villa Park, Illinois, 60181, at the above date and time. The meeting will provide potential bidders with an opportunity to view the site, buildings, and equipment prior to submitting a bid.

I I I I Separate, sealed proposals for the **M M I R R I I D I D M I I** will be received by the Village of Villa Park, Illinois, in the front office of the Village of Villa Park Iowa Community Center, 338 N Iowa Avenue, Villa Park, Illinois, 60181, until the Bid Deadline and then, immediately thereafter, the proposals will be publicly opened and read aloud. Notwithstanding the foregoing, the Village reserves the right to defer, postpone, delay, or reschedule the Bid Opening for such time and to such date as the Village, in its sole discretion, determines is in the best interest of the Village.

Proposals shall be submitted in accordance with the Bidding Documents prepared by the Village of Villa Park, 338 N Iowa Avenue, Villa Park, Illinois, 60181.

I D D R I I I I I I Bidders, in submitting a Bid, shall comply with all applicable Federal, State and Local laws and requirements; shall provide documentation of that compliance in accordance with the requirements of the Contract Documents or as requested by the Village; and, in submitting a Bid, Bidders affirm that they are qualified under all applicable laws and requirements to do so, and agree to be bound by the determination of the Village as to Bidder's compliance and qualifications.

I D I I I I R I Bid security in the amount of not less than five percent (5%) of the Bid shall accompany each Bid in accordance with the Bidding Documents.

RI The Bidder to whom a Contract is awarded shall be required to furnish both a Performance Bond and a Payment Bond acceptable to the Village for one-hundred percent (100%) of the Contract Price, in accordance with the requirements of the Contract Documents.

RI The Village will select the lowest, most responsible bidder. The Village reserves the right to reject any and all Bids, to waive any informalities or technicalities in bidding, and to accept the Bid which best serves the interests of the Village. The Village shall, in its sole discretion, determine what does or does not constitute an informality or technicality, and, in submitting a Bid, Bidder agrees to be bound by that determination.

The Village may make such investigations as it deems necessary to determine the ability of the Bidder to perform the Work, and the Bidder shall furnish to the Village all such information and data for this purpose as the Village may request. The Village reserves the right to reject any Bid if the evidence submitted by, or investigation of, such Bidder fails to satisfy the Village that such Bidder is properly qualified to carry out the obligations of the Agreement and to complete the Work contemplated therein.

R All applicable laws, ordinances, and the rules and regulations of all authorities having jurisdiction over construction of the PROJECT shall apply to the contract throughout.

R D M The Bidding Documents are on file for inspection at the front office of the Village of Villa Park Iowa Community Center, 338 N Iowa Avenue, Villa Park, Illinois, 60181, and may also be obtained from the Village of Villa Park Parks and Recreation Department at the address listed above for a non-refundable fee of twenty dollars (\$20.00).

I D R I I R D

NOT FOR BID

NOT FOR BID



Village of Villa Park

20 South Ardmore Avenue, Villa Park, Illinois 60181

□□□□□□□□□□□□□□□□

□□r□ □□□□□□r□□□□□

□r□□□□□□□

| | | |
|-----------------------|----------|----------|
| PROPOSAL SUBMITTED BY | | |
| Contractor's Name | | |
| Street | P.O. Box | |
| City | State | Zip Code |

STATE OF ILLINOIS

COUNTY OF DuPage

Village of Villa Park

(Name of City, Village, Town or Road District)

FOR THE IMPROVEMENT OF

PROJECT Community Recreation Building Demolition

LOCATION 320 East Wildwood Avenue, Villa Park, Illinois

TYPES OF FUNDS Local Funds

SPECIFICATIONS (required)



NOT FOR BID

Note: All proposal documents, including Proposal Guaranty Checks or Proposal Bid Bonds, should be stapled together to prevent loss when bids are processed.

I I I I I I I I I I I D R R

County DuPage

Local Public Agency Villa Park

Project Community Recreation Building Demolition

Location 320 E Wildwood Ave, Villa Park

Sealed proposals for the improvement described below will be received at the office of Iowa Community Center
338 North Iowa Avenue, Villa Park, Illinois 60181 until 10:00 AM on APRIL 25, 2023
 Address Time Date

Sealed proposals will be opened and read publicly at the office of Iowa Community Center
338 North Iowa Avenue, Villa Park, Illinois 60181 at 10:00 AM on APRIL 25, 2023
 Address Time Date

DESCRIPTION OF WORK

Name Community Recreation Building Demolition Length: N/A feet (N/A miles)

Location 320 East Wildwood Avenue, Villa Park, Illinois 60181

Proposed Work This project consists of the demolition of the Community Recreation Building, located at 320 East Wildwood Avenue in Villa Park, Illinois. The scope of work includes the demolition, removal, and offsite disposal of the structures, mechanical equipment, foundation walls, slabs, footings, pavement, playground, basketball courts, light poles, and other appurtenances; backfilling of all building excavations with clean fill; and other related and incidental work.

1. Plans and proposal forms will be available in the office of the Village of Villa Park Iowa Community Center,
338 North Iowa Avenue, Villa Park, Illinois, 60181, for a non-refundable fee of \$20.00.

2. Prequalification

3. The Awarding Authority reserves the right to waive technicalities and to reject any or all proposals as provided in BLRS Special Provision for Bidding Requirements and Conditions for Contract Proposals.

4. The following BLR Forms shall be returned by the bidder to the Awarding Authority:

- a. BLR 12200: Local Public Agency Formal Contract Proposal
- b. BLR 12200a Schedule of Prices
- c. BLR 12230: Proposal Bid Bond
- d. BLR 12326: Affidavit of Illinois Business Office

5. The quantities appearing in the bid schedule are approximate and are prepared for the comparison of bids. Payment to the Contractor will be made only for the actual quantities of work performed and accepted or materials furnished according to the contract. The scheduled quantities of work to be done and materials to be furnished may be increased, decreased or omitted as hereinafter provided.

6. Submission of a bid shall be conclusive assurance and warranty the bidder has examined the plans and understands all requirements for the performance of work. The bidder will be responsible for all errors in the proposal resulting from failure or neglect to conduct an in depth examination. The Awarding Authority will, in no case be responsible for any costs, expenses, losses or changes in anticipated profits resulting from such failure or neglect of the bidder.

7. The bidder shall take no advantage of any error or omission in the proposal and advertised contract.

8. If a special envelope is supplied by the Awarding Authority, each proposal should be submitted in that envelope furnished by the Awarding Agency and the blank spaces on the envelope shall be filled in correctly to clearly indicate its contents. When an envelope other than the special one furnished by the Awarding Authority is used, it shall be marked to clearly indicate its contents. When sent by mail, the sealed proposal shall be addressed to the Awarding Authority at the address and in care of the official in whose office the bids are to be received. All proposals shall be filed prior to the time and at the place specified in the Notice to Bidders. Proposals received after the time specified will be returned to the bidder unopened.

9. Permission will be given to a bidder to withdraw a proposal if the bidder makes the request in writing or in person before the time for opening proposals.



R

County DuPage
 Local Public Agency Village of Villa Park
 Project Community Recreation Building Demolition
 Location 320 E Wildwood Ave, Villa Park

1. Proposal of _____

for the following proposed work:

This project consists of the demolition of the Community Recreation Building, located at 320 East Wildwood Avenue in Villa Park, Illinois. The scope of work includes the demolition, removal, and offsite disposal of the structures, mechanical equipment, foundation walls, slabs, footings, pavement, playground, basketball courts, light poles, and other appurtenances; backfilling of all building excavations with clean fill; and other related and incidental work.

2. The plans for the proposed work are those prepared by the Village of Villa Park
3. The specifications referred to herein are those prepared by the Department of Transportation and designated as "Standard Specifications for Road and Bridge Construction" and the "Supplemental Specifications and Recurring Special Provisions" thereto, adopted and in effect on the date of invitation for bids.
4. The undersigned agrees to accept, as part of the contract, the applicable Special Provisions indicated on the "Check Sheet for Recurring Special Provisions" contained in this proposal.
5. The undersigned agrees to complete the work within 30 calendar days or before June 30, 2023, unless additional time is granted in accordance with the specifications.
6. A proposal guaranty in the proper amount, as specified in BLRS Special Provision for Bidding Requirements and Conditions for Contract Proposals, will be required. Bid Bonds will be allowed as a proposal guaranty. Accompanying this proposal is either a bid bond if allowed, on Department form BLR 12230 or a proposal guaranty check, complying with the specifications, made payable to:

Village Treasurer of the Village of Villa Park
 The amount of the check is 5% of Total Bid Amount (_____).

- ~~7. In the event that one proposal guaranty check is intended to cover two or more proposals, the amount must be equal to the sum of the proposal guaranties, which would be required for each individual proposal. If the proposal guaranty check is placed in another proposal, it will be found in the proposal for: Section Number N/A.~~
8. The successful bidder at the time of execution of the contract will be required to deposit a contract bond for the full amount of the award. When a contract bond is not required, the proposal guaranty check will be held in lieu thereof. If this proposal is accepted and the undersigned fails to execute a contract and contract bond as required, it is hereby agreed that the Bid Bond or check shall be forfeited to the Awarding Authority.
9. Each pay item should have a unit price and a total price. If no total price is shown or if there is a discrepancy between the product of the unit price multiplied by the quantity, the unit price shall govern. If a unit price is omitted, the total price will be divided by the quantity in order to establish a unit price.
10. A bid will be declared unacceptable if neither a unit price nor a total price is shown.
11. The undersigned submits herewith the schedule of prices on BLR 12200a covering the work to be performed under this contract.
12. The undersigned further agrees that if awarded the contract for the sections contained in the combinations on BLR 12200a, the work shall be in accordance with the requirements of each individual proposal for the multiple bid specified in the Schedule for Multiple Bids below.

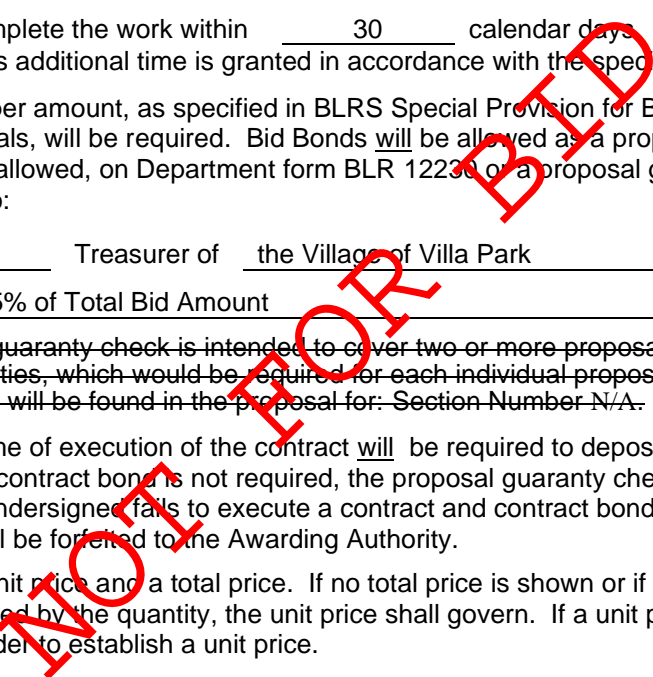



Village of Villa Park

20 South Ardmore Avenue, Villa Park, Illinois 60181

D R I

County DuPage
 Local Agency Villa Park
 Project Community Recreation Building
Demolition
 Location 320 East Wildwood, Villa Park

d r d

(For complete information covering these items, see plans and specifications)

| Item No. | Items | Unit | Quantity | Unit Price | Total |
|----------|--|-------|----------|------------|-------|
| 1 | DEMOLITION, REMOVAL, AND DISPOSAL | L SUM | 1 | | |
| 2 | EROSION, SITE, DUST, AND TRAFFIC CONTROL | L SUM | 1 | | |
| 3 | BACKFILLING | L SUM | 1 | | |
| 4 | PERMITTING | L SUM | 1 | | |

NOT FOR BID

| | |
|--|--|
| Bidder's Proposal for making Entire Improvements | |
|--|--|



I R

County DuPage

Local Public Agency Village of Villa Park

Project Community Recreation Building Demolition

Location 320 East Wildwood, Villa Park

(If an individual)

Signature of Bidder _____

Business Address _____

(If a partnership)

Firm Name _____

Signed By _____

Business Address _____

Inset Names and Addressed of All Partners



NOT FOR BID

(If a corporation)

Corporate Name _____

Signed By _____

President

Business Address _____

Inset Names of Officers



President _____

Secretary _____

Treasurer _____

Attest: _____
Secretary



Village of Villa Park

20 South Ardmore Avenue, Villa Park, Illinois 60181

Local Agency Proposal Bid Bond

Location 320 East Wildwood, Villa Park

County DuPage

Local Agency Village of Villa Park

Project Community Rec Bld Demolition

RETURN WITH BID

PAPER BID BOND

WE _____ as PRINCIPAL,

and _____ as SURETY,

are held jointly, severally and firmly bound unto the above Local Agency (hereafter referred to as "LA") in the penal sum of 5% of the total bid price, or for the amount specified in the proposal documents in effect on the date of invitation for bids whichever is the lesser sum. We bind ourselves, our heirs, executors, administrators, successors, and assigns, jointly pay to the LA this sum under the conditions of this instrument.

WHEREAS THE CONDITION OF THE FOREGOING OBLIGATION IS SUCH that, the said PRINCIPAL is submitting a written proposal to the LA acting through its awarding authority for the construction of the work designated as the above section.

THEREFORE if the proposal is accepted and a contract awarded to the PRINCIPAL by the LA for the above designated section and the PRINCIPAL shall within fifteen (15) days after award enter into a formal contract, furnish surety guaranteeing the faithful performance of the work, and furnish evidence of the required insurance coverage, all as provided in the "Standard Specifications for Road and Bridge Construction" and applicable Supplemental Specifications, then this obligation shall become void; otherwise it shall remain in full force and effect.

IN THE EVENT the LA determines the PRINCIPAL has failed to enter into a formal contract in compliance with any requirements set forth in the preceding paragraph, then the LA acting through its awarding authority shall immediately be entitled to recover the full penal sum set out above, together with all court costs, all attorney fees, and any other expense of recovery.

IN TESTIMONY WHEREOF, the said PRINCIPAL and the said SURETY have caused this instrument to be signed by their respective officers this _____ day of _____

Principal

(Company Name)

(Company Name)

By: _____
(Signature and Title)

By: _____
(Signature and Title)

(If PRINCIPAL is a joint venture of two or more contractors, the company names and authorized signatures of each contractor must be affixed.)

Surety

(Name of Surety)

By: _____
(Signature of Attorney-in-Fact)

STATE OF ILLINOIS,

COUNTY OF _____

I, _____, a Notary Public in and for said county,

do hereby certify that _____

(Insert names of individuals signing on behalf of PRINCIPAL & SURETY)

who are each personally known to me to be the same persons whose names are subscribed to the foregoing instrument on behalf of PRINCIPAL and SURETY, appeared before me this day in person and acknowledged respectively, that they signed and delivered said instruments as their free and voluntary act for the uses and purposes therein set forth.

Given under my hand and notarial seal this _____ day of _____

My commission expires _____
(Notary Public)

ELECTRONIC BID BOND

Electronic bid bond is allowed (box must be checked by LA if electronic bid bond is allowed)

The Principal may submit an electronic bid bond, in lieu of completing the above section of the Proposal Bid Bond Form. By providing an electronic bid bond ID code and signing below, the Principal is ensuring the identified electronic bid bond has been executed and the Principal and Surety are firmly bound unto the LA under the conditions of the bid bond as shown above. (If PRINCIPAL is a joint venture of two or more contractors, an electronic bid bond ID code, company/Bidder name title and date must be affixed for each contractor in the venture.)

Electronic Bid Bond ID Code

(Company/Bidder Name)

(Signature and Title)

Date

RETURN WITH BID



Village of Villa Park

20 South Ardmore Avenue, Villa Park, Illinois 60181

Affidavit of Illinois Business Office

County DuPage
 Local Agency Village of Villa Park
 Project Community Rec Bld Demolition
 Location 320 East Wildwood, Villa Park

State of _____)
) ss.
 County of _____)

I, _____ of _____, _____,
 (Name of Affiant) (City of Affiant) (State of Affiant)

being first duly sworn upon oath, states as follows:

1. That I am the _____ of _____
 officer or position bidder
2. That I have personal knowledge of the facts herein stated.
3. That, if selected under this proposal, _____, will maintain a
 (bidder)
 business office in the State of Illinois which will be located in _____ County, Illinois.
4. That this business office will serve as the primary place of employment for any persons employed in the construction contemplated by this proposal.
5. That this Affidavit is given as a requirement of state law as provided in Section 30-22(8) of the Illinois Procurement Code.

NOT FOR BID

(Signature)

(Print Name of Affiant)

This instrument was acknowledged before me on _____ day of _____, 2023.

(SEAL)

(Signature of Notary Public)

INDEX
FOR
SUPPLEMENTAL SPECIFICATIONS
AND RECURRING SPECIAL PROVISIONS

Adopted January 1, 2022

This index contains a listing of SUPPLEMENTAL SPECIFICATIONS, frequently used RECURRING SPECIAL PROVISIONS, and LOCAL ROADS AND STREETS RECURRING SPECIAL PROVISIONS.

No ERRATA this year.

SUPPLEMENTAL SPECIFICATIONS

Std. Spec. Sec.

Page No.

No Supplemental Specifications this year.

NOT FOR BID



Check Sheet for Recurring Special Provisions

Print Form

Print With Instructions

Reset Form

Local Public Agency

County

Section Number

Village of Villa Park

DuPage

Check this box for lettings prior to 01/01/2022.

The Following Recurring Special Provisions Indicated By An "X" Are Applicable To This Contract And Are Included By Reference:

Recurring Special Provisions

| Check Sheet # | | Reference Page No. |
|---------------|---|--------------------|
| 1 | <input type="checkbox"/> Additional State Requirements for Federal-Aid Construction Contracts | 1 |
| 2 | <input type="checkbox"/> Subletting of Contracts (Federal-Aid Contracts) | 4 |
| 3 | <input type="checkbox"/> EEO | 5 |
| 4 | <input type="checkbox"/> Specific EEO Responsibilities Non Federal-Aid Contracts | 15 |
| 5 | <input type="checkbox"/> Required Provisions - State Contracts | 20 |
| 6 | <input type="checkbox"/> Asbestos Bearing Pad Removal | 26 |
| 7 | <input type="checkbox"/> Asbestos Waterproofing Membrane and Asbestos HMA Surface Removal | 27 |
| 8 | <input type="checkbox"/> Temporary Stream Crossings and In-Stream Work Pads | 28 |
| 9 | <input type="checkbox"/> Construction Layout Stakes | 29 |
| 10 | <input type="checkbox"/> Use of Geotextile Fabric for Railroad Crossing | 32 |
| 11 | <input type="checkbox"/> Subsealing of Concrete Pavements | 34 |
| 12 | <input type="checkbox"/> Hot-Mix Asphalt Surface Correction | 38 |
| 13 | <input type="checkbox"/> Pavement and Shoulder Resurfacing | 40 |
| 14 | <input type="checkbox"/> Patching with Hot-Mix Asphalt Overlay Removal | 41 |
| 15 | <input type="checkbox"/> Polymer Concrete | 43 |
| 16 | <input type="checkbox"/> PVC Pipeliner | 45 |
| 17 | <input type="checkbox"/> Bicycle Racks | 46 |
| 18 | <input type="checkbox"/> Temporary Portable Bridge Traffic Signals | 48 |
| 19 | <input type="checkbox"/> Nighttime Inspection of Roadway Lighting | 50 |
| 20 | <input type="checkbox"/> English Substitution of Metric Bolts | 51 |
| 21 | <input type="checkbox"/> Calcium Chloride Accelerator for Portland Cement Concrete | 52 |
| 22 | <input type="checkbox"/> Quality Control of Concrete Mixtures at the Plant | 53 |
| 23 | <input type="checkbox"/> Quality Control/Quality Assurance of Concrete Mixtures | 61 |
| 24 | <input type="checkbox"/> Digital Terrain Modeling for Earthwork Calculations | 77 |
| 25 | <input type="checkbox"/> Preventive Maintenance - Bituminous Surface Treatment (A-1) | 79 |
| 26 | <input type="checkbox"/> Temporary Raised Pavement Markers | 85 |
| 27 | <input type="checkbox"/> Restoring Bridge Approach Pavements Using High-Density Foam | 86 |
| 28 | <input type="checkbox"/> Portland Cement Concrete Inlay or Overlay | 89 |
| 29 | <input type="checkbox"/> Portland Cement Concrete Partial Depth Hot-Mix Asphalt Patching | 93 |
| 30 | <input type="checkbox"/> Longitudinal Joint and Crack Patching | 96 |
| 31 | <input type="checkbox"/> Concrete Mix Design - Department Provided | 98 |
| 32 | <input type="checkbox"/> Station Numbers in Pavements or Overlays | 99 |

NOT FOR BID

Village of Villa Park

DuPage

The Following Local Roads And Streets Recurring Special Provisions Indicated By An "X" Are Applicable To This Contract And Are Included By Reference:

Local Roads And Streets Recurring Special Provisions

| <u>Check Sheet #</u> | | <u>Page No.</u> |
|----------------------|--|-----------------|
| LRS 1 | Reserved | 101 |
| LRS 2 | <input type="checkbox"/> Furnished Excavation | 102 |
| LRS 3 | <input checked="" type="checkbox"/> Work Zone Traffic Control Surveillance | 103 |
| LRS 4 | <input checked="" type="checkbox"/> Flaggers in Work Zones | 104 |
| LRS 5 | <input checked="" type="checkbox"/> Contract Claims | 105 |
| LRS 6 | <input checked="" type="checkbox"/> Bidding Requirements and Conditions for Contract Proposals | 106 |
| LRS 7 | <input type="checkbox"/> Bidding Requirements and Conditions for Material Proposals | 112 |
| LRS 8 | Reserved | 118 |
| LRS 9 | <input type="checkbox"/> Bituminous Surface Treatments | 119 |
| LRS 10 | Reserved | 123 |
| LRS 11 | <input checked="" type="checkbox"/> Employment Practices | 124 |
| LRS 12 | <input checked="" type="checkbox"/> Wages of Employees on Public Works | 126 |
| LRS 13 | <input checked="" type="checkbox"/> Selection of Labor | 128 |
| LRS 14 | <input type="checkbox"/> Paving Brick and Concrete Paver Pavements and Sidewalks | 129 |
| LRS 15 | <input checked="" type="checkbox"/> Partial Payments | 132 |
| LRS 16 | <input checked="" type="checkbox"/> Protests on Local Lettings | 133 |
| LRS 17 | <input checked="" type="checkbox"/> Substance Abuse Prevention Program | 134 |
| LRS 18 | <input type="checkbox"/> Multigrade Cold Mix Asphalt | 135 |
| LRS 19 | <input type="checkbox"/> Reflective Crack Control Treatment | 136 |

NOT FOR BID

PAY ITEM #4 – PERMITTING 13

SPECIAL PROVISION FOR INSURANCE (LR 107-4)

BDE SPECIAL PROVISIONS

APPENDIX A: PREVAILING WAGE RATES

APPENDIX B: VILLAGE OF VILLA PARK BIDDER REQUIREMENTS ORDINANCE

APPENDIX C: IRMA CONTRACTUAL INSURANCE GUIDELINES

APPENDIX D: LOCATION MAPS

APPENDIX E: REPORTS

Geotechnical Investigation

Geotechnical CCDD Report

Asbestos Survey Report

Lead Survey Report

Air Quality Sampling Professional Report

NOT FOR BID

I R I

The following Special Provisions supplement the “Standard Specifications for Road and Bridge Construction”, adopted January 1, 2022 (referred to hereinafter as the Standard Specifications); and the “Supplemental Specifications and Recurring Special Provisions”, adopted January 1, 2022. In case of conflict with any part or parts of said Specifications, these Special Provisions shall take precedence and shall govern. Where no conflict exists, the said Specifications shall apply to this Contract as if repeated in their entirety herein.

D I I I I

r The individual, firm, partnership, joint venture, or corporation contracting with the Village of Villa Park for performance of prescribed work.

D r The Village of Villa Park, DuPage County, Illinois.

r The Resident Engineer who is the authorized representative of the Village of Villa Park in immediate charge of the engineering details of a construction project.

I R

Community Recreation Building
320 East Wildwood Avenue
Villa Park, Illinois 60181

R I I R

This project consists of the demolition of the Community Recreation Building, located at 320 East Wildwood Avenue in Villa Park, Illinois. The scope of work includes the demolition, removal, and offsite disposal of the structures, mechanical equipment, foundation walls, slabs, footings, pavement, playground, basketball courts, light poles, and other appurtenances; backfilling of all building excavations with clean fill; and other related and incidental work.

R I D D

The project does not include any utility disconnects. The project does not include removal or disposal of asbestos or any other hazardous waste.

NOT FOR BID

RRIR

IDDR

Bidders will comply with all applicable Federal, State and local laws and requirements, and will further meet the qualifications prescribed in this and other applicable portions of these provisions.

Bidder, in submitting a Bid, certifies that Bidder is in compliance with all applicable Federal, State and local laws and requirements, and that Bidder further meets the qualifications prescribed in this and other applicable portions of these provisions. Engineer's determination as to the compliance and qualifications of the Bidder will be final, and Bidder, in submitting a Bid, agrees to be bound by that determination.

Bidder, in submitting a Bid, certifies that Bidder is in compliance with the following requirements and qualifications. Bidder further certifies that Bidder is able to provide written evidence of Bidder's compliance with the following requirements and qualifications. Bidder shall, upon request by Engineer, submit such written evidence within five (5) calendar days of the Engineer's request, as well as any other written evidence which Engineer may deem necessary for the purpose of evaluating Bidder's qualifications.

- (a) Bidder shall be qualified to do business in the State of Illinois.
- (b) Bidder shall possess either a valid Federal Employer Tax Identification Number (FEIN) or a valid Social Security Number (SSN).
- (c) Bidder shall be able to provide a street address and description of the Bidder's place of business, and the mailing address of the business, if different from the street address.
- (d) Bidder shall be able to provide the number of years Bidder has been engaged in the contracting business under the present firm name, and the name of the state where incorporated.
- (e) Bidder shall be able to provide a list of the property and equipment available to the Bidder.
- (f) Bidder shall be able to provide a financial statement demonstrating that the Bidder has the financial resources to meet all obligations related to the Work.
- (g) Bidder shall maintain insurance policies with the coverages required by the Contract, and with the minimum limits of coverage required by the Contract. Bidder shall be able to provide current certificate(s) of insurance for the

insurance policies held by Bidder, demonstrating that Bidder holds insurance policies with the coverages required by the contract, and with the minimum limits of coverage required by the Contract.

- (h) Bidder shall have constructed a minimum of three (3) projects of a similar nature in the immediate past five (5) years. Bidder shall be able to provide a list of all projects of a similar nature constructed by Bidder in the immediate past five (5) years, which list shall contain the minimum of three (3) such projects, which list shall provide a description and the location(s) of all such projects, and shall contain the Bidder's performance record and references, as well as the names and current contact information, including addresses and telephone numbers, of persons who acted as owners' representatives for those projects and who have knowledge of those projects, and whom Bidder agrees the Village may contact for the purpose of verifying Bidder's performance and references.
- (i) Bidder shall be able to provide a list of three (3) references (name, address and telephone number) with knowledge of the integrity and business practices of the bidder. Such references may not be persons who have been employed by Bidder as employees.
- (j) Bidder shall be able to provide a list of projects presently under Contract, the awarded Contract amount of each, the approximate adjusted Contract amount of each (if applicable), and the dollar amount or percent of completion of each.
- (k) Bidder shall be able to provide a list of Contracts which have resulted in lawsuits, whether against Bidder as a prime contractor, against Bidder as a subcontractor, or against Bidder as a party in any other capacity; or against subcontractors or suppliers performing work for Bidder or under Contract held by Bidder.
- (l) Bidder shall be able to provide a list of Contracts defaulted.
- (m) Bidder shall be able to provide a statement indicating whether or not Bidder has ever filed bankruptcy.
- (n) Bidder shall be able to provide a list of all officers of the firm, which list shall also indicate those officers who, while in the employ of the firm or in the employ of previous firms, were associated with Contracts which resulted in lawsuits, Contracts defaulted, or firms which filed for bankruptcy.
- (o) Bidder shall maintain personnel guaranteed to be employed in the responsible charge of the Work, which personnel possess sufficient technical experience to ensure the satisfactory completion of the Work. Bidder shall be able to provide the names and technical experience of such personnel, as well as

statements as to whether the personnel have or have not performed satisfactorily on other contracts of like nature and magnitude or comparable difficulty at similar rate of progress.

- (p) Bidder shall be able to provide a list of subcontractors and suppliers anticipated to be employed by Bidder for the purpose of completing the Work, including the firm name, street address and description of place of business; mailing address of business (if different); phone, fax and e-mail contact information of business; name of primary contact; and a list of any projects or contracts for which Bidder currently owes monies to said firm, which list shall include a description of the project or contract, the amount currently due to said firm, the period of time for which those monies have been owed, and the expected date of payment of those monies.
- (q) Bidder shall participate in active apprenticeship and training programs approved by and registered with the United States Department of Labor Bureau of Apprenticeship and Training for each of the trades of work contemplated under the Contract. Bidder shall be able to provide evidence of Bidder's participation in such apprenticeship and training programs.
- (r) Bidder shall only employ subcontractors who meet the requirements prescribed in this section and other sections of these specifications.
- (s) Bidder shall be able to provide such other information as may assist the Village in determining whether the Bidder is adequately prepared to fulfill the Contract.

These requirements and qualifications are not intended to discourage bidding, to make it difficult for qualified Bidders to submit Bids, or to discourage beginning contractors. The purpose of these requirements and qualifications is to allow the Village to obtain sufficient information about Bidder's financial state, available equipment, personnel, and previous work experience so that the Village may mitigate the hazards involved in awarding contracts to parties who may not be qualified to perform the Work as specified.

A copy of Village of Villa Park Ordinance No. 3733, amending the requirements of bidders for construction projects, is provided as Appendix B.

IDRM

All bids shall remain subject to acceptance by the Village for a period of 60 calendar days from the date of the bid opening. The Village may extend the acceptance period by up to an additional 60 calendar days upon written notice to all bidders by the Village. The Village may, in its sole discretion, release any bid and return the bid bond prior to the end of the acceptance period.

RR

Add the following paragraph to the end of Article 108.01 of the Standard Specifications:

“The apparent low Bidder shall submit to the Village within 3 calendar days after the receipt of bids, a list of the names of Bidder’s proposed subcontractors and material suppliers along with a description of the work to be performed or the materials to be supplied by each.”

IR

Insurance and indemnification shall be in accordance with applicable sections of the Standard Specifications, and shall also be in accordance with the “IRMA Contractual Insurance Guidelines”, incorporated herein as Appendix C. If a conflict is determined to exist between the requirements prescribed in the Standard Specifications and the requirements prescribed in the IRMA Contractual Insurance Guidelines, such conflict will be resolved as follows:

- a. If a particular type of insurance coverage is required by one standard but not by both, that type of insurance coverage will be required.
- b. If the minimum limits of insurance coverage required by one standard differ from those required by the other standard, the higher minimum limits of insurance coverage will prevail.
- c. If any other conflicts are determined to exist between the requirements prescribed in the two standards, the stricter of the two requirements will prevail. The Village will make the final determination as to what constitutes a stricter requirement.

MIR

Mobilization shall be in accordance with Section 671 of the Standard Specifications, except as modified herein.

Revise Article 671.02, Basis of Payment, to read:

“ This work will not be paid for separately but shall be included in the unit bid prices of the items for which this work applies.”

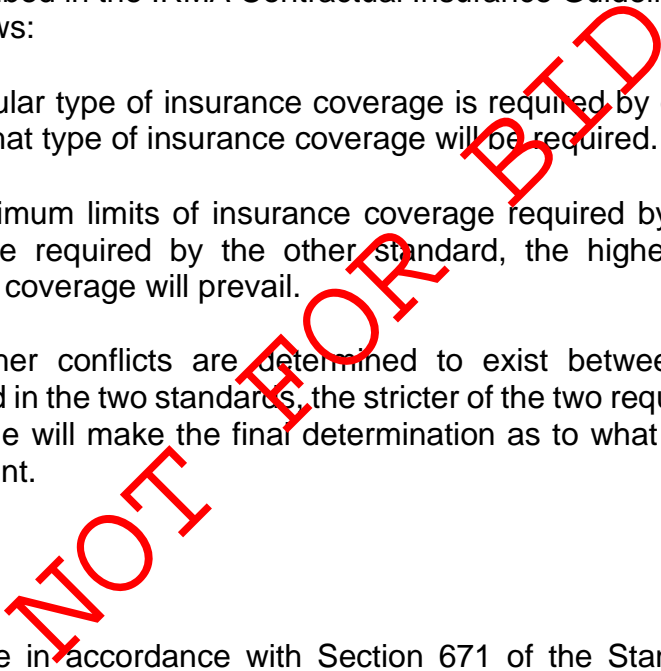

NOT FOR BID

MRRI

MR-DMRI RMDD

D This work shall consist of the demolition, removal, and offsite disposal of the structures, mechanical equipment, foundation walls, slabs, footings, pavement, playground, basketball courts, light poles, and other appurtenances as described herein.

This work shall include, but not be limited to, the demolition, removal, and disposal of the building, structures, foundation walls, slabs, footings, pavement, concrete, fences, pipes, equipment, playground, basketball courts, light poles, other appurtenances, amenities, materials, and all other items existing on site at the time of work. All items, materials, and equipment shall become the property of the Contractor and immediately following demolition shall be removed from the site by the Contractor and lawfully disposed of offsite in accordance with all federal, state, and local regulations and requirements.

M This work will be measured for payment on a lump sum basis. No measurement will be made of any of the individual components of this work.

This work will be paid for at the contract lump sum price for DEMOLITION, REMOVAL, AND DISPOSAL, which price shall include all labor, equipment, materials, and other costs necessary to complete the work as described.

MR-RI DRIR

D This work shall consist of furnishing, installing, maintaining, relocating, and removing erosion, site, and traffic control measures. This work shall be in accordance with applicable portions of Section 280, Section 282, and Division 700 of the Standard Specifications, and as described herein.

Erosion control measures shall include perimeter erosion barrier, inlet filter baskets, construction entrances, and other measures as deemed necessary by the Village.

Perimeter erosion barrier shall be placed continuously in all unpaved areas adjacent to the area of construction, and shall be supported with stakes at regular intervals. The bottom edge of the perimeter erosion barrier shall be installed below grade. Barrier which is ripped, gapped at the bottom, or otherwise in such a condition so as to allow silt or sediment to pass through it shall be removed and replaced by the Contractor immediately.

Inlet filters shall consist of fabric bags mounted on metal frames, and shall be of proper shape and size so as to fit the castings in which they are to be installed. Inlet filters shall be installed in all drainage and utility structures to which the construction area is tributary, and also in all those structures that are otherwise within fifty feet of the construction area.

Inlet filters shall be emptied no less than once per week, after every rainfall, or more often if needed.

Construction entrances or other measures shall be required for ensuring that vehicles and equipment leaving the site or moving through the site do not carry or deposit dirt, silt, mud, or other debris in the performance of the work. Construction entrances or other such measures as agreed upon shall be to the satisfaction of the Village.

Contractor shall provide site control measures as needed or as deemed necessary by the Village. Such measures shall be sufficient for preventing unauthorized access to the site.

Site control measures shall include furnishing and erecting continuous six-foot (6') chain link fence around the perimeter of all areas of proposed work. Contractor may maintain existing chain link fence in place for the purpose of fulfilling this requirement. Contractor may also re-use existing chain link fence for the purpose of fulfilling this requirement. Regardless of how Contractor elects to fulfill this requirement, Contractor shall be responsible for providing the labor, equipment, and materials necessary to maintain continuous six-foot chain link fence in place around the perimeter of all areas of proposed work under this contract.

Contractor shall provide dust control measures as needed or as deemed necessary by the Village. Such measures shall be sufficient for preventing the transmission of dust and all other airborne material or particulate beyond the limits of the construction site. Such measures may include the application of water by approved methods, the mechanical sweeping of the construction site or adjacent areas, or other measures as necessary. Such measures shall conform with all applicable laws and regulations.

Contractor shall provide traffic control measures as needed or as deemed necessary by the Village.

Traffic control measures shall include, but not be limited to, road closures or lane closures for work taking place in or adjacent to any roadways; flaggers for vehicles and equipment entering or leaving the site; and barricades on any driveway entrances or sidewalks to which access is to be restricted. Contractor shall be responsible for ensuring that all traffic control devices are in satisfactory condition, conform to minimum reflectivity standards, and are equipped with beacons. Traffic control devices shall be either Type II barricades, Type III barricades, or barrels. Traffic cones or similar will not be considered acceptable traffic control devices and will not be permitted.

M This work will be measured for payment on a lump sum basis. No measurement will be made of any of the individual components of this work.

This work will be paid for at the contract lump sum price for EROSION, SITE, AND TRAFFIC CONTROL, which price shall include all labor, equipment, materials, and other costs necessary to complete the work as described.

MR-

D This work shall consist of the furnishing, placement, and mechanical compaction of clean, suitable CA-6 backfill material in all building excavations resulting from the demolition and removal work included in this contract as described herein.

Material to be furnished shall be subject to the inspection and approval of the Village. Material shall have sufficient compressive strength to accommodate the loading of construction equipment following its placement. Material shall be reasonably free of unsuitable or deleterious contents as determined by the Village.

Material to be furnished shall be certified for disposal at a Clean Construction and Demolition Debris (CCDD) site in accordance with the appropriate requirements established by State of Illinois law and Illinois Environmental Protection Agency regulations. Contractor shall be required to provide documentation of said certification.

Contractor shall place approved backfill material in all building excavations resulting from the demolition and removal work included in this contract. Backfill material shall be mechanically compacted in all locations where it is installed, in lifts not exceeding 24 in. loose measure, to the satisfaction of the Village. If necessary, Contractor shall provide multiple types or units of equipment for the purpose of providing mechanical compaction if site conditions or other circumstances prevent Contractor from achieving satisfactory compaction with the types or units of equipment initially provided.

Contractor shall place and compact backfill material to an elevation such that all existing drainage patterns are maintained and such that positive drainage of the site following construction is achieved.

M This work will be measured for payment on a lump sum basis. No measurement will be made of any of the individual components of this work.

This work will be paid for at the contract lump sum price for BACKFILLING, which price shall include all labor, equipment, materials, and other costs necessary to complete the work as described.

MRMI

D This work shall consist of obtaining and meeting the conditions of all applicable permits required for this work.

Contractor shall be responsible for obtaining all permits from all agencies having jurisdiction over the work.

Contractor shall apply for and obtain a demolition permit and a stormwater certification from the Village of Villa Park Public Works Department. No fees will be charged by the Village for these permits, but Contractor shall otherwise meet all conditions thereof.

All other permits which are required for the performance of the work shall be obtained from the appropriate agencies by the Contractor at the Contractor's expense. The cost of such applications, all associated fees, and conformance with all conditions thereof shall be included in the cost of this work.

M This work will be measured for payment on a lump sum basis. No measurement will be made of any of the individual components of this work.

This work will be paid for at the contract lump sum price for PERMITTING, which price shall include all labor, equipment, materials, and other costs necessary to complete the work as described.

NOT FOR BID

State of Illinois
Department of Transportation
Bureau of Local Roads and Streets

SPECIAL PROVISION
FOR
INSURANCE

Effective: February 1, 2007
Revised: August 1, 2007

All references to Sections or Articles in this specification shall be construed to mean specific Section or Article of the Standard Specifications for Road and Bridge Construction, adopted by the Department of Transportation.

The Contractor shall name the following entities as additional insured under the Contractor's general liability insurance policy in accordance with Article 107.27:

Village of Villa Park

The entities listed above and their officers, employees, and agents shall be indemnified and held harmless in accordance with Article 107.26.

NOT FOR BID

BDE SPECIAL PROVISIONS
For the November 18, 2022 Letting

The following special provisions indicated by a “check mark” are applicable to this contract and will be included by the Project Coordination and Implementation Section of the BD&E. An * indicates a new or revised special provision for the letting.

| File Name | # | | Special Provision Title | Effective | Revised |
|-----------|-------|-------------------------------------|---|---------------|---------------|
| 80099 | 1 | <input type="checkbox"/> | Accessible Pedestrian Signals (APS) | April 1, 2003 | Jan. 1, 2022 |
| 80274 | 2 | <input type="checkbox"/> | Aggregate Subgrade Improvement | April 1, 2012 | April 1, 2022 |
| 80192 | 3 | <input type="checkbox"/> | Automated Flagger Assistance Device | Jan. 1, 2008 | |
| 80173 | 4 | <input type="checkbox"/> | Bituminous Materials Cost Adjustments | Nov. 2, 2006 | Aug. 1, 2017 |
| 80426 | 5 | <input type="checkbox"/> | Bituminous Surface Treatment with Fog Seal | Jan. 1, 2020 | Jan. 1, 2022 |
| 80436 | 6 | <input type="checkbox"/> | Blended Finely Divided Minerals | April 1, 2021 | |
| 80241 | 7 | <input type="checkbox"/> | Bridge Demolition Debris | July 1, 2009 | |
| 50531 | 8 | <input type="checkbox"/> | Building Removal | Sept. 1, 1990 | Aug. 1, 2022 |
| 50261 | 9 | <input type="checkbox"/> | Building Removal with Asbestos Abatement | Sept. 1, 1990 | Aug. 1, 2022 |
| 80384 | 10 | <input type="checkbox"/> | Compensable Delay Costs | June 2, 2017 | April 1, 2019 |
| 80198 | 11 | <input checked="" type="checkbox"/> | Completion Date (via calendar days) | April 1, 2008 | |
| 80199 | 12 | <input type="checkbox"/> | Completion Date (via calendar days) Plus Working Days | April 1, 2008 | |
| 80293 | 13 | <input type="checkbox"/> | Concrete Box Culverts with Skews > 30 Degrees and Design Fills ≤ 5 Feet | April 1, 2012 | July 1, 2016 |
| 80311 | 14 | <input type="checkbox"/> | Concrete End Sections for Pipe Culverts | Jan. 1, 2013 | April 1, 2016 |
| 80261 | 15 | <input checked="" type="checkbox"/> | Construction Air Quality – Diesel Retrofit | June 1, 2010 | Nov. 1, 2014 |
| 80434 | 16 | <input type="checkbox"/> | Corrugated Plastic Pipe (Culvert and Storm Sewer) | Jan. 1, 2021 | |
| 80029 | 17 | <input type="checkbox"/> | Disadvantaged Business Enterprise Participation | Sept. 1, 2000 | March 2, 2019 |
| 80229 | 18 | <input type="checkbox"/> | Fuel Cost Adjustment | April 1, 2009 | Aug. 1, 2017 |
| 80433 | 19 | <input type="checkbox"/> | Green Preformed Thermoplastic Pavement Markings | Jan. 1, 2021 | Jan. 1, 2022 |
| 80422 | 20 | <input type="checkbox"/> | High Tension Cable Median Barrier | Jan. 1, 2020 | Jan. 1, 2022 |
| 80443 | 21 | <input type="checkbox"/> | High Tension Cable Median Barrier Removal | April 1, 2022 | |
| 80442 | 22 | <input type="checkbox"/> | Hot-Mix Asphalt | Jan. 1, 2022 | Aug. 1, 2022 |
| * | 80446 | <input type="checkbox"/> | Hot-Mix Asphalt - Longitudinal Joint Sealant | Nov. 1, 2022 | |
| | 80444 | <input type="checkbox"/> | Hot-Mix Asphalt - Patching | April 1, 2022 | |
| | 80438 | <input type="checkbox"/> | Illinois Works Apprenticeship Initiative – State Funded Contracts | June 2, 2021 | Sept. 2, 2021 |
| | 80411 | <input type="checkbox"/> | Luminaires, LED | April 1, 2019 | Jan. 1, 2022 |
| | 80045 | <input type="checkbox"/> | Material Transfer Device | June 15, 1999 | Jan. 1, 2022 |
| | 80418 | <input type="checkbox"/> | Mechanically Stabilized Earth Retaining Walls | Nov. 1, 2019 | Nov. 1, 2020 |
| | 80430 | <input type="checkbox"/> | Portland Cement Concrete – Haul Time | July 1, 2020 | |
| | 34261 | <input type="checkbox"/> | Railroad Protective Liability Insurance | Dec. 1, 1986 | Jan. 1, 2022 |
| * | 80445 | <input type="checkbox"/> | Seeding | Nov. 1, 2022 | |
| | 80395 | <input type="checkbox"/> | Sloped Metal End Section for Pipe Culverts | Jan. 1, 2018 | |
| | 80340 | <input type="checkbox"/> | Speed Display Trailer | April 2, 2014 | Jan. 1, 2022 |
| | 80127 | <input type="checkbox"/> | Steel Cost Adjustment | April 2, 2004 | Jan. 1, 2022 |
| | 80397 | <input type="checkbox"/> | Subcontractor and DBE Payment Reporting | April 2, 2018 | |
| | 80391 | <input type="checkbox"/> | Subcontractor Mobilization Payments | Nov. 2, 2017 | April 1, 2019 |
| * | 80437 | <input checked="" type="checkbox"/> | Submission of Payroll Records | April 1, 2021 | Nov. 1, 2022 |
| | 80435 | <input type="checkbox"/> | Surface Testing of Pavements – IRI | Jan. 1, 2021 | Jan. 1, 2022 |
| | 80410 | <input type="checkbox"/> | Traffic Spotters | Jan. 1, 2019 | |
| | 20338 | <input type="checkbox"/> | Training Special Provisions | Oct. 15, 1975 | Sept. 2, 2021 |
| | 80318 | <input type="checkbox"/> | Traversable Pipe Grate for Concrete End Sections | Jan. 1, 2013 | Jan. 1, 2018 |
| | 80429 | <input type="checkbox"/> | Ultra-Thin Bonded Wearing Course | April 1, 2020 | Jan. 1, 2022 |
| * | 80439 | <input checked="" type="checkbox"/> | Vehicle and Equipment Warning Lights | Nov. 1, 2021 | Nov. 1, 2022 |
| | 80440 | <input type="checkbox"/> | Waterproofing Membrane System | Nov. 1, 2021 | |
| | 80302 | <input type="checkbox"/> | Weekly DBE Trucking Reports | June 2, 2012 | Nov. 1, 2021 |
| | 80427 | <input checked="" type="checkbox"/> | Work Zone Traffic Control Devices | Mar. 2, 2020 | |
| | 80071 | <input type="checkbox"/> | Working Days | Jan. 1, 2002 | |

The following special provisions have been deleted from use.

| <u>File Name</u> | <u>Special Provision Title</u> | <u>Effective</u> | <u>Revised</u> |
|------------------|---|------------------|----------------|
| 5048I | Building Removal-Case II (Non-Friable Asbestos) | Sept. 1, 1990 | April 1, 2010 |
| 5049I | Building Removal-Case III (Friable Asbestos) | Sept. 1, 1990 | April 1, 2010 |

The following special provisions are in the 2022 Standard Specifications and Recurring Special Provisions.

| <u>File Name</u> | <u>Special Provision Title</u> | <u>New Location(s)</u> | <u>Effective</u> | <u>Revised</u> |
|------------------|--|--|------------------|----------------|
| 80425 | Cape Seal | Sections 405, 1003 | Jan. 1, 2020 | Jan. 1, 2021 |
| 80387 | Contrast Preformed Plastic Pavement Marking | Articles 780.08, 1095.03 | Nov. 1, 2017 | |
| 80402 | Disposal Fees | Article 109.04(b) | Nov. 1, 2018 | |
| 80378 | Dowel Bar Inserter | Articles 420.03, 420.05, 1103.20 | Jan. 1, 2017 | Jan. 1, 2018 |
| 80421 | Electric Service Installation | Articles 804.04, 804.05 | Jan. 1, 2020 | |
| 80415 | Emulsified Asphalts | Article 1032.06 | Aug. 1, 2019 | |
| 80423 | Engineer's Field Office and Laboratory | Section 670 | Jan. 1, 2020 | |
| 80417 | Geotechnical Fabric for Pipe Underdrains and French Drains | Articles 1080.01(a), 1080.05 | Nov. 1, 2019 | |
| 80420 | Geotextile Retaining Walls | Article 1080.06(d) | Nov. 1, 2019 | |
| 80304 | Grooving for Recessed Pavement Markings | Articles 780.05, 780.14, 780.15 | Nov. 1, 2012 | Nov. 1, 2020 |
| 80416 | Hot-Mix Asphalt – Binder and Surface Course | Sections 406, 1003, 1004, 1030, 1101 | July 2, 2019 | Nov. 1, 2019 |
| 80398 | Hot-Mix Asphalt – Longitudinal Joint Sealant | Sections 406, 1032 | Aug. 1, 2018 | Nov. 1, 2019 |
| 80406 | Hot-Mix Asphalt – Mixture Design Verification and Production (Modified for I-FIT) | Sections 406, 1030 | Jan. 1, 2019 | Jan. 2, 2021 |
| 80347 | Hot-Mix Asphalt – Pay for Performance Using Percent Within Limits – Jobsite Sampling | Sections 406, 1030 | Nov. 1, 2014 | July 2, 2019 |
| 80383 | Hot-Mix Asphalt – Quality Control for Performance | Sections 406, 1030 | April 1, 2017 | July 2, 2019 |
| 80393 | Manholes, Valve Vaults, and Flat Slab Tops | Articles 602.02, 1042.10 | Jan. 1, 2018 | Mar. 1, 2019 |
| 80424 | Micro-Surfacing and Slurry Sealing | Sections 404, 1093 | Jan. 1, 2020 | Jan. 1, 2021 |
| 80428 | Mobilization | Article 671.02 | April 1, 2020 | |
| 80412 | Obstruction Warning Luminaires, LED | Sections 801, 822, 1067 | Aug. 1, 2019 | |
| 80359 | Portland Cement Concrete Bridge Deck Curing | Articles 1020.13, 1022.03 | April 1, 2015 | Nov. 1, 2019 |
| 80431 | Portland Cement Concrete Pavement Patching | Article 701.17(e)(3)b, 1001.01(d), 1020.05(a)(5) | July 1, 2020 | |
| 80432 | Portland Cement Concrete Pavement Placement | Article 420.07 | July 1, 2020 | |
| 80300 | Preformed Plastic Pavement Marking Type D Inlaid | Articles 780.08, 1095.03 | April 1, 2012 | April 1, 2016 |
| 80157 | Railroad Protective Liability Insurance (5 and 10) | Article 107.11 | Jan. 1, 2006 | |
| 80306 | Reclaimed Asphalt Pavement (RAP) and Reclaimed Asphalt Shingles (RAS) | Section 1031 | Nov. 1, 2012 | Jan. 2, 2021 |
| 80407 | Removal and Disposal of Regulated Substances | Section 669 | Jan. 1 2019 | Jan. 1, 2020 |
| 80419 | Silt Fence, Inlet Filters, Ground Stabilization and Riprap Filter Fabric | Articles 280.02, 280.04, 1080.02, 1080.03, 1081.15 | Nov. 1, 2019 | July 1, 2021 |
| 80408 | Steel Plate Beam Guardrail Manufacturing | Article 1006.25 | Jan. 1, 2019 | |
| 80413 | Structural Timber | Article 1007.03 | Aug. 1, 2019 | |
| 80298 | Temporary Pavement Marking | Section 703, Article 1095.06 | April 1, 2012 | April 1, 2017 |
| 80409 | Traffic Control Devices – Cones | Article 701.15(a), 1106.02(b) | Jan. 1, 2019 | |
| 80288 | Warm Mix Asphalt | Sections 406, 1030, 1102 | Jan. 1, 2012 | April 1, 2016 |
| 80414 | Wood Fence Sight Screen | Article 641.02 | Aug. 1, 2019 | April 1, 2020 |

The following special provisions require additional information from the designer. The additional information needs to be submitted as a separate document. The Project Coordination and Implementation section will then include the information in the applicable special provision.

- Bridge Demolition Debris
- Building Removal
- Building Removal with Asbestos Abatement
- Completion Date
- Completion Date Plus Working Days
- DBE Participation
- Railroad Protective Liability Insurance
- Training Special Provisions
- Working Days

COMPLETION DATE (VIA CALENDAR DAYS) (BDE)

Effective: April 1, 2008

The Contractor shall complete all work on or before the completion date of this contract which will be based upon 30 calendar days.

The completion date will be determined by adding the specified number of calendar days to the date the Contractor begins work, or to the date ten days after execution of the contract, whichever is the earlier, unless a delayed start is granted by the Engineer.

80198

NOT FOR BID

□□□□R□□□I□□□IR□□□□I□□□DI□□□□R□R□□I□□□D□□□

Effective: June 1, 2010

Revised: November 1, 2014

The reduction of emissions of particulate matter (PM) for off-road equipment shall be accomplished by installing retrofit emission control devices. The term "equipment" refers to diesel fuel powered devices rated at 50 hp and above, to be used on the jobsite in excess of seven calendar days over the course of the construction period on the jobsite (including rental equipment).

Contractor and subcontractor diesel powered off-road equipment assigned to the contract shall be retrofitted using the phased in approach shown below. Equipment that is of a model year older than the year given for that equipment's respective horsepower range shall be retrofitted:

| Effective Dates | Horsepower Range | Model Year |
|----------------------------|------------------|------------|
| June 1, 2010 ^{1/} | 600-749 | 2002 |
| | 750 and up | 2006 |
| June 1, 2011 ^{2/} | 100-299 | 2003 |
| | 300-599 | 2001 |
| | 600-749 | 2002 |
| | 750 and up | 2006 |
| June 1, 2012 ^{2/} | 50-99 | 2004 |
| | 100-299 | 2003 |
| | 300-599 | 2001 |
| | 600-749 | 2002 |
| | 750 and up | 2006 |

1/ Effective dates apply to Contractor diesel powered off-road equipment assigned to the contract.

2/ Effective dates apply to Contractor and subcontractor diesel powered off-road equipment assigned to the contract.

The retrofit emission control devices shall achieve a minimum PM emission reduction of 50 percent and shall be:

- a) Included on the U.S. Environmental Protection Agency (USEPA) *Verified Retrofit Technology List* (<http://www.epa.gov/cleandiesel/verification/verif-list.htm>), or verified by the California Air Resources Board (CARB) (<http://www.arb.ca.gov/diesel/verdev/vt/cvt.htm>); or
- b) Retrofitted with a non-verified diesel retrofit emission control device if verified retrofit emission control devices are not available for equipment proposed to be used on the project, and if the Contractor has obtained a performance certification from the retrofit

device manufacturer that the emission control device provides a minimum PM emission reduction of 50 percent.

Note: Large cranes (Crawler mounted cranes) which are responsible for critical lift operations are exempt from installing retrofit emission control devices if such devices adversely affect equipment operation.

Diesel powered off-road equipment with engine ratings of 50 hp and above, which are unable to be retrofitted with verified emission control devices or if performance certifications are not available which will achieve a minimum 50 percent PM reduction, may be granted a waiver by the Department if documentation is provided showing good faith efforts were made by the Contractor to retrofit the equipment.

Construction shall not proceed until the Contractor submits a certified list of the diesel powered off-road equipment that will be used, and as necessary, retrofitted with emission control devices. The list(s) shall include (1) the equipment number, type, make, Contractor/rental company name; and (2) the emission control devices make, model, USEPA or CARB verification number, or performance certification from the retrofit device manufacturer. Equipment reported as fitted with emissions control devices shall be made available to the Engineer for visual inspection of the device installation, prior to being used on the jobsite.

The Contractor shall submit an updated list of retrofitted off-road construction equipment as retrofitted equipment changes or comes on to the jobsite. The addition or deletion of any diesel powered equipment shall be included on the updated list.

If any diesel powered off-road equipment is found to be in non-compliance with any portion of this special provision, the Engineer will issue the Contractor a diesel retrofit deficiency deduction.

Any costs associated with retrofitting any diesel powered off-road equipment with emission control devices shall be considered as included in the contract unit prices bid for the various items of work involved and no additional compensation will be allowed. The Contractor's compliance with this notice and any associated regulations shall not be grounds for a claim.

D R D D D

When the Engineer determines that a diesel retrofit deficiency exists, a daily monetary deduction will be imposed for each calendar day or fraction thereof the deficiency continues to exist. The calendar day(s) will begin when the time period for correction is exceeded and end with the Engineer's written acceptance of the correction. The daily monetary deduction will be \$1,000.00 for each deficiency identified.

The deficiency will be based on lack of diesel retrofit emissions control.

If a Contractor accumulates three diesel retrofit deficiency deductions for the same piece of equipment in a contract period, the Contractor will be shutdown until the deficiency is corrected.

Such a shutdown will not be grounds for any extension of the contract time, waiver of penalties, or be grounds for any claim.

80261

NOT FOR BID

PAYMENTS TO SUBCONTRACTORS (BDE)

Effective: November 2, 2017

Add the following to the end of the fourth paragraph of Article 109.11 of the Standard Specifications:

“If reasonable cause is asserted, written notice shall be provided to the applicable subcontractor and/or material supplier and the Engineer within five days of the Contractor receiving payment. The written notice shall identify the contract number, the subcontract or material purchase agreement, a detailed reason for refusal, the value of payment being withheld, and the specific remedial actions required of the subcontractor and/or material supplier so that payment can be made.”

80390

NOT FOR BID

RRRMMDD

Effective: November 2, 2013

Revise Article 109.07(a) of the Standard Specifications to read:

“(a) Progress Payments. At least once each month, the Engineer will make a written estimate of the quantity of work performed in accordance with the contract, and the value thereof at the contract unit prices. The amount of the estimate approved as due for payment will be vouchered by the Department and presented to the State Comptroller for payment. No amount less than \$1000.00 will be approved for payment other than the final payment.

Progress payments may be reduced by liens filed pursuant to Section 23(c) of the Mechanics’ Lien Act, 770 ILCS 60/23(c).

If a Contractor or subcontractor has defaulted on a loan issued under the Department’s Disadvantaged Business Revolving Loan Program (20 ILCS 2705/2705-610), progress payments may be reduced pursuant to the terms of that loan agreement. In such cases, the amount of the estimate related to the work performed by the Contractor or subcontractor, in default of the loan agreement, will be offset, in whole or in part, and vouchered by the Department to the Working Capital Revolving Fund or designated escrow account. Payment for the work shall be considered as issued and received by the Contractor or subcontractor on the date of the offset voucher. Further, the amount of the offset voucher shall be a credit against the Department’s obligation to pay the Contractor, the Contractor’s obligation to pay the subcontractor, and the Contractor’s or subcontractor’s total loan indebtedness to the Department. The offset shall continue until such time as the entire loan indebtedness is satisfied. The Department will notify the Contractor and Fund Control Agent in a timely manner of such offset. The Contractor or subcontractor shall not be entitled to additional payment in consideration of the offset.

The failure to perform any requirement, obligation, or term of the contract by the Contractor shall be reason for withholding any progress payments until the Department determines that compliance has been achieved.”

MI I R R RD D

Effective: April 1, 2021

Revised: November 1, 2022

FEDERAL AID CONTRACTS. Revise the following section of Check Sheet #1 of the Recurring Special Provisions to read:

“STATEMENTS AND PAYROLLS

The payroll records shall include the worker’s name, the worker’s address, the worker’s telephone number when available, the worker’s social security number, the worker’s classification or classifications, the worker’s gross and net wages paid in each pay period, the worker’s number of hours worked each day, and the worker’s starting and ending times of work each day. However, any Contractor or subcontractor who remits contributions to a fringe benefit fund that is not jointly maintained and jointly governed by one or more employers and one or more labor organization must additionally submit the worker’s hourly wage rate, the worker’s hourly overtime wage rate, the worker’s hourly fringe benefit rates, the name and address of each fringe benefit fund, the plan sponsor of each fringe benefit, if applicable, and the plan administrator of each fringe benefit, if applicable.

The Contractor and each subcontractor shall certify and submit payroll records to the Department each week from the start to the completion of their respective work, except that full social security numbers shall not be included on weekly submittals. Instead, the payrolls shall include an identification number for each employee (e.g., the last four digits of the employee’s social security number). In addition, starting and ending times of work each day may be omitted from the payroll records submitted. The submittals shall be made using LCPTracker Pro software. The software is web-based and can be accessed at <https://lcptracker.com/>. When there has been no activity during a work week, a payroll record shall still be submitted with the appropriate option (“No Work”, “Suspended”, or “Complete”) selected.”

STATE CONTRACTS. Revise Item 3 of Section IV of Check Sheet #5 of the Recurring Special Provisions to read:

- “3. Submission of Payroll Records. The Contractor and each subcontractor shall, no later than the 15th day of each calendar month, file a certified payroll for the immediately preceding month to the Illinois Department of Labor (IDOL) through the Illinois Prevailing Wage Portal in compliance with the State Prevailing Wage Act (820 ILCS 130). The portal can be found on the IDOL website at <https://www2.illinois.gov/idol/Laws-Rules/CONMED/Pages/Prevailing-Wage-Portal.aspx>. Payrolls shall be submitted in the format prescribed by the IDOL.

In addition to filing certified payroll(s) with the IDOL, the Contractor and each subcontractor shall certify and submit payroll records to the Department each week from the start to the completion of their respective work, except that full social security numbers shall not be included on weekly submittals. Instead, the payrolls shall include an

identification number for each employee (e.g., the last four digits of the employee's social security number). In addition, starting and ending times of work each day may be omitted from the payroll records submitted. The submittals shall be made using LCPtracker Pro software. The software is web-based and can be accessed at <https://lcptracker.com/>. When there has been no activity during a work week, a payroll record shall still be submitted with the appropriate option ("No Work", "Suspended", or "Complete") selected."

80437

NOT FOR BID

□□□I□□□□□D□□□□I□M□□□□□ □R□I□□□□I□□□□□□D□□□

Effective: November 1, 2021

Revised: November 1, 2022

Add the following paragraph after the first paragraph of Article 701.08 of the Standard Specifications:

“The Contractor shall equip all vehicles and equipment with high-intensity oscillating, rotating, or flashing, amber or amber-and-white, warning lights which are visible from all directions. In accordance with 625 ILCS 5/12-215, the lights may only be in operation while the vehicle or equipment is engaged in construction operations.”

80439

NOT FOR BID

attenuators), truck mounted attenuators, and other devices not meeting the definitions of Category 1 or 2. Category 3 devices manufactured after December 31, 2019 shall be MASH-16 compliant. Category 3 devices manufactured on or before December 31, 2019, and compliant with NCHRP 350 or MASH 2009, may be used on contracts let before December 31, 2029. Category 3 devices shall be crash tested for Test Level 3 or the test level specified.

Category 4 includes portable or trailer-mounted devices such as arrow boards, changeable message signs, temporary traffic signals, and area lighting supports. It is preferable for Category 4 devices manufactured after December 31, 2019 to be MASH-16 compliant; however, there are currently no crash tested devices in this category, so it remains exempt from the NCHRP 350 or MASH compliance requirement.

For each type of device, when no more than one MASH-16 compliant is available, an NCHRP 350 or MASH-2009 compliant device may be used, even if manufactured after December 31, 2019.”

Revise Articles 1106.02(g), 1106.02(k), and 1106.02(l) to read:

“(g) Truck Mounted/Trailer Mounted Attenuators. The attenuator shall be approved for use at Test Level 3. Test Level 2 may be used for normal posted speeds less than or equal to 45 mph.

(k) Temporary Water Filled Barrier. The water filled barrier shall be a lightweight plastic shell designed to accept water ballast and be on the Department’s qualified product list.

Shop drawings shall be furnished by the manufacturer and shall indicate the deflection of the barrier as determined by acceptance testing; the configuration of the barrier in that test; and the vehicle weight, velocity, and angle of impact of the deflection test. The Engineer shall be provided one copy of the shop drawings.

(l) Movable Traffic Barrier. The movable traffic barrier shall be on the Department’s qualified product list.

Shop drawings shall be furnished by the manufacturer and shall indicate the deflection of the barrier as determined by acceptance testing; the configuration of the barrier in that test; and the vehicle weight, velocity, and angle of impact of the deflection test. The Engineer shall be provided one copy of the shop drawings. The barrier shall be capable of being moved on and off the roadway on a daily basis.”

**COMMUNITY RECREATON BUILDING DEMOLITION
VILLAGE OF VILLA PARK**

APPENDIX A

PREVAILING WAGE RATES

NOT FOR BID

NOT FOR BID

DuPage County Prevailing Wage Rates posted on 3/1/2023

| Trade Title | Rg | Type | C | Base | Foreman | Overtime | | | | H/W | Pension | Vac | Trng | Other Ins |
|--------------------------|-----|------|---|-------|---------|----------|-----|-----|-----|-------|---------|------|------|-----------|
| | | | | | | M-F | Sa | Su | Hol | | | | | |
| ASBESTOS ABT-GEN | All | ALL | | 47.40 | 48.40 | 1.5 | 1.5 | 2.0 | 2.0 | 17.05 | 15.21 | 0.00 | 0.90 | |
| ASBESTOS ABT-MEC | All | BLD | | 39.60 | 42.77 | 1.5 | 1.5 | 2.0 | 2.0 | 14.77 | 13.59 | 0.00 | 0.86 | |
| BOILERMAKER | All | BLD | | 53.66 | 58.48 | 2.0 | 2.0 | 2.0 | 2.0 | 6.97 | 23.69 | 0.00 | 2.67 | |
| BRICK MASON | All | BLD | | 49.81 | 54.79 | 1.5 | 1.5 | 2.0 | 2.0 | 12.10 | 21.56 | 0.00 | 1.10 | |
| CARPENTER | All | ALL | | 52.01 | 54.01 | 1.5 | 1.5 | 2.0 | 2.0 | 11.79 | 24.76 | 1.50 | 0.80 | |
| CEMENT MASON | All | ALL | | 49.75 | 51.75 | 2.0 | 1.5 | 2.0 | 2.0 | 17.08 | 20.74 | 0.00 | 1.00 | |
| CERAMIC TILE FINISHER | All | BLD | | 44.18 | 44.18 | 1.5 | 1.5 | 2.0 | 2.0 | 12.25 | 14.77 | 0.00 | 1.00 | |
| CERAMIC TILE LAYER | All | BLD | | 51.44 | 55.44 | 1.5 | 1.5 | 2.0 | 2.0 | 12.25 | 18.48 | 0.00 | 1.08 | |
| COMMUNICATION TECHNICIAN | All | BLD | | 35.92 | 38.72 | 1.5 | 1.5 | 2.0 | 2.0 | 13.60 | 24.04 | 3.20 | 0.83 | |
| ELECTRIC PWR EQMT OP | All | ALL | | 47.56 | 64.89 | 1.5 | 1.5 | 2.0 | 2.0 | 7.00 | 13.32 | 0.00 | 1.19 | 1.43 |
| ELECTRIC PWR GRNDMAN | All | ALL | | 36.53 | 64.89 | 1.5 | 1.5 | 2.0 | 2.0 | 7.00 | 10.23 | 0.00 | 0.92 | 1.10 |
| ELECTRIC PWR LINEMAN | All | ALL | | 57.17 | 64.89 | 1.5 | 1.5 | 2.0 | 2.0 | 7.00 | 16.01 | 0.00 | 1.43 | 1.72 |
| ELECTRIC PWR TRK DRV | All | ALL | | 37.86 | 64.89 | 1.5 | 1.5 | 2.0 | 2.0 | 7.00 | 10.61 | 0.00 | 0.95 | 1.14 |
| ELECTRICIAN | All | BLD | | 43.08 | 47.33 | 1.5 | 1.5 | 2.0 | 2.0 | 13.60 | 27.57 | 7.13 | 1.20 | |
| ELEVATOR CONSTRUCTOR | All | BLD | | 62.47 | 70.28 | 2.0 | 2.0 | 2.0 | 2.0 | 16.03 | 20.21 | 5.00 | 0.65 | |
| FENCE ERECTOR | NE | ALL | | 46.89 | 48.89 | 1.5 | 1.5 | 2.0 | 2.0 | 13.68 | 17.42 | 0.00 | 0.75 | |
| FENCE ERECTOR | W | ALL | | 48.83 | 52.74 | 2.0 | 2.0 | 2.0 | 2.0 | 13.31 | 25.25 | 0.00 | 1.28 | |
| GLAZIER | All | BLD | | 48.75 | 51.25 | 1.5 | 2.0 | 2.0 | 2.0 | 15.19 | 24.43 | 0.00 | 1.70 | |
| HEAT/FROST INSULATOR | All | BLD | | 52.80 | 57.97 | 1.5 | 1.5 | 2.0 | 2.0 | 14.77 | 16.76 | 0.00 | 0.86 | |
| IRON WORKER | E | ALL | | 55.81 | 57.81 | 2.0 | 2.0 | 2.0 | 2.0 | 16.05 | 25.31 | 0.00 | 0.49 | |
| IRON WORKER | W | ALL | | 48.83 | 52.74 | 2.0 | 2.0 | 2.0 | 2.0 | 13.31 | 25.25 | 0.00 | 1.28 | |
| LABORER | All | ALL | | 47.40 | 48.15 | 1.5 | 1.5 | 2.0 | 2.0 | 17.05 | 15.21 | 0.00 | 0.90 | |
| LATHER | All | ALL | | 52.01 | 54.01 | 1.5 | 1.5 | 2.0 | 2.0 | 11.79 | 24.76 | 1.50 | 0.80 | |
| MACHINIST | All | BLD | | 53.18 | 57.18 | 1.5 | 1.5 | 2.0 | 2.0 | 9.93 | 8.95 | 1.85 | 1.47 | |
| MARBLE FINISHER | All | ALL | | 38.00 | 51.41 | 1.5 | 1.5 | 2.0 | 2.0 | 12.10 | 19.60 | 0.00 | 0.60 | |
| MARBLE SETTER | All | BLD | | 48.96 | 53.86 | 1.5 | 1.5 | 2.0 | 2.0 | 12.10 | 21.03 | 0.00 | 0.78 | |
| MATERIAL TESTER I | All | ALL | | 37.40 | | 1.5 | 1.5 | 2.0 | 2.0 | 17.05 | 15.21 | 0.00 | 0.90 | |
| MATERIALS TESTER II | All | ALL | | 42.40 | | 1.5 | 1.5 | 2.0 | 2.0 | 17.05 | 15.21 | 0.00 | 0.90 | |
| MILLWRIGHT | All | ALL | | 52.01 | 54.01 | 1.5 | 1.5 | 2.0 | 2.0 | 11.79 | 24.76 | 1.50 | 0.80 | |
| OPERATING ENGINEER | All | BLD | 1 | 55.10 | 59.10 | 2.0 | 2.0 | 2.0 | 2.0 | 22.15 | 19.30 | 2.00 | 2.55 | |
| OPERATING ENGINEER | All | BLD | 2 | 53.80 | 59.10 | 2.0 | 2.0 | 2.0 | 2.0 | 22.15 | 19.30 | 2.00 | 2.55 | |

| | | | | | | | | | | | | | | |
|--------------------------|-----|-----|---|-------|-------|-----|-----|-----|-----|-------|-------|------|------|------|
| OPERATING ENGINEER | All | BLD | 3 | 51.25 | 59.10 | 2.0 | 2.0 | 2.0 | 2.0 | 22.15 | 19.30 | 2.00 | 2.55 | |
| OPERATING ENGINEER | All | BLD | 4 | 49.50 | 59.10 | 2.0 | 2.0 | 2.0 | 2.0 | 22.15 | 19.30 | 2.00 | 2.55 | |
| OPERATING ENGINEER | All | BLD | 5 | 58.85 | 59.10 | 2.0 | 2.0 | 2.0 | 2.0 | 22.15 | 19.30 | 2.00 | 2.55 | |
| OPERATING ENGINEER | All | BLD | 6 | 56.10 | 59.10 | 2.0 | 2.0 | 2.0 | 2.0 | 22.15 | 19.30 | 2.00 | 2.55 | |
| OPERATING ENGINEER | All | BLD | 7 | 58.10 | 59.10 | 2.0 | 2.0 | 2.0 | 2.0 | 22.15 | 19.30 | 2.00 | 2.55 | |
| OPERATING ENGINEER | All | FLT | | 41.00 | 41.00 | 1.5 | 1.5 | 2.0 | 2.0 | 20.90 | 17.85 | 2.00 | 2.15 | |
| OPERATING ENGINEER | All | HWY | 1 | 53.30 | 57.30 | 1.5 | 1.5 | 2.0 | 2.0 | 22.15 | 19.30 | 2.00 | 2.55 | |
| OPERATING ENGINEER | All | HWY | 2 | 52.75 | 57.30 | 1.5 | 1.5 | 2.0 | 2.0 | 22.15 | 19.30 | 2.00 | 2.55 | |
| OPERATING ENGINEER | All | HWY | 3 | 50.70 | 57.30 | 1.5 | 1.5 | 2.0 | 2.0 | 22.15 | 19.30 | 2.00 | 2.55 | |
| OPERATING ENGINEER | All | HWY | 4 | 49.30 | 57.30 | 1.5 | 1.5 | 2.0 | 2.0 | 22.15 | 19.30 | 2.00 | 2.55 | |
| OPERATING ENGINEER | All | HWY | 5 | 48.10 | 57.30 | 1.5 | 1.5 | 2.0 | 2.0 | 22.15 | 19.30 | 2.00 | 2.55 | |
| OPERATING ENGINEER | All | HWY | 6 | 56.30 | 57.30 | 1.5 | 1.5 | 2.0 | 2.0 | 22.15 | 19.30 | 2.00 | 2.55 | |
| OPERATING ENGINEER | All | HWY | 7 | 54.30 | 57.30 | 1.5 | 1.5 | 2.0 | 2.0 | 22.15 | 19.30 | 2.00 | 2.55 | |
| ORNAMENTAL IRON WORKER | E | ALL | | 53.32 | 55.82 | 2.0 | 2.0 | 2.0 | 2.0 | 14.23 | 25.00 | 0.00 | 1.75 | |
| ORNAMENTAL IRON WORKER | W | ALL | | 48.83 | 52.74 | 2.0 | 2.0 | 2.0 | 2.0 | 13.31 | 25.25 | 0.00 | 1.28 | |
| PAINTER | All | ALL | | 50.30 | 52.30 | 1.5 | 1.5 | 2.0 | 2.0 | 19.73 | 4.15 | 0.00 | 1.55 | |
| PAINTER - SIGNS | All | BLD | | 41.55 | 46.67 | 1.5 | 1.5 | 2.0 | 2.0 | 3.04 | 3.90 | 0.00 | 0.00 | |
| PILEDRIVER | All | ALL | | 52.01 | 54.01 | 1.5 | 1.5 | 2.0 | 2.0 | 11.79 | 24.76 | 1.50 | 0.80 | |
| PIPEFITTER | All | BLD | | 53.00 | 56.00 | 1.5 | 1.5 | 2.0 | 2.0 | 11.85 | 22.85 | 0.00 | 2.92 | |
| PLASTERER | All | BLD | | 49.85 | 52.84 | 1.5 | 1.5 | 2.0 | 2.0 | 12.10 | 21.48 | 0.00 | 1.09 | |
| PLUMBER | All | BLD | | 54.80 | 58.00 | 1.5 | 1.5 | 2.0 | 2.0 | 16.70 | 17.04 | 0.00 | 1.58 | |
| ROOFER | All | BLD | | 48.00 | 53.00 | 1.5 | 1.5 | 2.0 | 2.0 | 11.83 | 15.26 | 0.00 | 0.99 | |
| SHEETMETAL WORKER | All | BLD | | 53.33 | 56.00 | 1.5 | 1.5 | 2.0 | 2.0 | 11.85 | 19.43 | 0.00 | 1.59 | 2.54 |
| SPRINKLER FITTER | All | BLD | | 51.55 | 57.30 | 1.5 | 1.5 | 2.0 | 2.0 | 14.20 | 18.70 | 0.00 | 0.75 | |
| STEEL ERECTOR | E | ALL | | 55.81 | 57.81 | 2.0 | 2.0 | 2.0 | 2.0 | 16.05 | 25.31 | 0.00 | 0.49 | |
| STEEL ERECTOR | W | ALL | | 48.83 | 52.74 | 2.0 | 2.0 | 2.0 | 2.0 | 13.31 | 25.25 | 0.00 | 1.28 | |
| STONE MASON | All | BLD | | 49.81 | 54.79 | 1.5 | 1.5 | 2.0 | 2.0 | 12.10 | 21.56 | 0.00 | 1.10 | |
| TERRAZZO FINISHER | All | BLD | | 45.57 | 45.57 | 1.5 | 1.5 | 2.0 | 2.0 | 12.25 | 17.14 | 0.00 | 1.03 | |
| TERRAZZO MECHANIC | All | BLD | | 49.41 | 52.91 | 1.5 | 1.5 | 2.0 | 2.0 | 12.25 | 18.60 | 0.00 | 1.07 | |
| TRAFFIC SAFETY WORKER I | All | HWY | | 39.30 | 40.90 | 1.5 | 1.5 | 2.0 | 2.0 | 9.65 | 9.10 | 0.00 | 0.10 | |
| TRAFFIC SAFETY WORKER II | ALL | HWY | | 40.30 | 41.90 | 1.5 | 1.5 | 2.0 | 2.0 | 9.65 | 9.10 | 0.00 | 0.10 | |
| TRUCK DRIVER | All | ALL | 1 | 41.06 | 41.61 | 1.5 | 1.5 | 2.0 | 2.0 | 10.83 | 14.15 | 0.00 | 0.15 | |
| TRUCK DRIVER | All | ALL | 2 | 41.21 | 41.61 | 1.5 | 1.5 | 2.0 | 2.0 | 10.83 | 14.15 | 0.00 | 0.15 | |
| TRUCK DRIVER | All | ALL | 3 | 41.41 | 41.61 | 1.5 | 1.5 | 2.0 | 2.0 | 10.83 | 14.15 | 0.00 | 0.15 | |
| TRUCK DRIVER | All | ALL | 4 | 41.61 | 41.61 | 1.5 | 1.5 | 2.0 | 2.0 | 10.83 | 14.15 | 0.00 | 0.15 | |
| TUCKPOINTER | All | BLD | | 49.53 | 50.53 | 1.5 | 1.5 | 2.0 | 2.0 | 9.04 | 21.06 | 0.00 | 1.07 | |

Legend

Rg Region

Type Trade Type - All,Highway,Building,Floating,Oil & Chip,Rivers

C Class

Base Base Wage Rate

OT M-F Unless otherwise noted, OT pay is required for any hour greater than 8 worked each day, Mon through Fri. The number listed is the multiple of the base wage.

OT Sa Overtime pay required for every hour worked on Saturdays

OT Su Overtime pay required for every hour worked on Sundays

OT Hol Overtime pay required for every hour worked on Holidays

H/W Health/Welfare benefit

Vac Vacation

Trng Training

Other Ins Employer hourly cost for any other type(s) of insurance provided for benefit of worker.

Explanations DUPAGE COUNTY

IRON WORKERS AND FENCE ERECTOR (WEST) - West of Route 53.

The following list is considered as those days for which holiday rates of wages for work performed apply: New Years Day, Memorial Day, Fourth of July, Labor Day, Thanksgiving Day, Christmas Day and Veterans Day in some classifications/counties. Generally, any of these holidays which fall on a Sunday is celebrated on the following Monday. This then makes work performed on that Monday payable at the appropriate overtime rate for holiday pay. Common practice in a given local may alter certain days of celebration. If in doubt, please check with IDOL.

EXPLANATION OF CLASSES

ASBESTOS - GENERAL - removal of asbestos material/mold and hazardous materials from any place in a building, including mechanical systems where those mechanical systems are to be removed. This includes the removal of asbestos materials/mold and hazardous materials from ductwork or pipes in a building when the building is to be demolished at the time or at some close future date.

ASBESTOS - MECHANICAL - removal of asbestos material from mechanical systems, such as pipes, ducts, and boilers, where the mechanical systems are to remain.

TRAFFIC SAFETY Worker I

Traffic Safety Worker I - work associated with the delivery, installation, pick-up and servicing of safety devices during periods of roadway construction, including such work as set-up and maintenance of barricades, barrier wall reflectors, drums, cones, delineators, signs, crash attenuators, glare screen and other such items, and the layout and application or removal of conflicting and/or temporary roadway markings utilized to control traffic in construction zones, as well as flagging for these operations.

TRAFFIC SAFETY WORKER II

Work associated with the installation and removal of permanent pavement markings and/or pavement markers including both installations performed by hand and installations performed by truck.

CERAMIC TILE FINISHER

NOT FOR BID

The grouting, cleaning, and polishing of all classes of tile, whether for interior or exterior purposes, all burned, glazed or unglazed products; all composition materials, granite tiles, warning detectable tiles, cement tiles, epoxy composite materials, pavers, glass, mosaics, fiberglass, and all substitute materials, for tile made in tile-like units; all mixtures in tile like form of cement, metals, and other materials that are for and intended for use as a finished floor surface, stair treads, promenade roofs, walks, walls, ceilings, swimming pools, and all other places where tile is to form a finished interior or exterior. The mixing of all setting mortars including but not limited to thin-set mortars, epoxies, wall mud, and any other sand and cement mixtures or adhesives when used in the preparation, installation, repair, or maintenance of tile and/or similar materials. The handling and unloading of all sand, cement, lime, tile, fixtures, equipment, adhesives, or any other materials to be used in the preparation, installation, repair, or maintenance of tile and/or similar materials. Ceramic Tile Finishers shall fill all joints and voids regardless of method on all tile work, particularly and especially after installation of said tile work. Application of any and all protective coverings to all types of tile installations including, but not be limited to, all soap compounds, paper products, tapes, and all polyethylene coverings, plywood, masonite, cardboard, and any new type of products that may be used to protect tile installations, Blastrac equipment, and all floor scarifying equipment used in preparing floors to receive tile. The clean up and removal of all waste and materials. All demolition of existing tile floors and walls to be re-tiled.

COMMUNICATIONS TECHNICIAN

Low voltage installation, maintenance and removal of telecommunication facilities (voice, sound, data and video) including telephone and data inside wire, interconnect, terminal equipment, central offices, PABX, fiber optic cable and equipment, micro waves, V-SAT, bypass, CATV, WAN (wide area networks), LAN (local area networks), and ISDN (integrated system digital network), pulling of wire in raceways, but not the installation of raceways.

MARBLE FINISHER

Loading and unloading trucks, distribution of all materials (all stone, sand, etc.), stocking of floors with material, performing all rigging for heavy work, the handling of all material that may be needed for the installation of such materials, building of scaffolding, polishing if needed, patching, waxing of material if damaged, pointing up, caulking, grouting and cleaning of marble, holding water on diamond or Carborundum blade or saw for setters cutting, use of tub saw or any other saw needed for preparation of material, drilling of holes for wires that anchor material set by setters, mixing up of molding plaster for installation of material, mixing up thin set for the installation of material, mixing up of sand to cement for the installation of material and such other work as may be required in helping a Marble Setter in the handling of all material in the erection or installation of interior marble, slate, travertine, art marble, serpentine, albertine stone, blue stone, granite and other stones (meaning as to stone any foreign or domestic materials as are specified and used in building interiors and exteriors and customarily known as stone in the trade), carrara, sanionyx, vitrolite and similar, opaque glass and the laying of all marble tile, terrazzo tile, slate tile and precast tile, steps, risers treads, base, or any other materials that may be used as substitutes for any of the aforementioned materials and which are used on interior and exterior which are installed in a similar manner.

MATERIAL TESTER I: Hand coring and drilling for testing of materials; field inspection of uncured concrete and asphalt.

MATERIAL TESTER II: Field inspection of welds, structural steel, fireproofing, masonry, soil, facade, reinforcing steel, formwork, cured concrete, and concrete and asphalt batch plants; adjusting proportions of bituminous mixtures.

OPERATING ENGINEER - BUILDING

Class 1. Asphalt Plant; Asphalt Spreader; Autograde; Backhoes with Caisson Attachment; Batch Plant; Benoto (requires Two Engineers); Boiler and Throttle Valve; Caisson Rigs; Central Redi-Mix Plant; Combination Back Hoe Front End-loader Machine; Compressor and Throttle Valve; Concrete Breaker (Truck Mounted); Concrete Conveyor; Concrete Conveyor (Truck Mounted); Concrete Paver Over 27E cu. ft; Concrete Paver 27E cu. ft. and Under; Concrete Placer; Concrete Placing Boom; Concrete Pump (Truck Mounted); Concrete Tower; Cranes, All; Cranes, Hammerhead; Cranes, (GCI and similar Type); Creter Crane; Spider Crane; Crusher, Stone, etc.; Derricks, All; Derricks, Traveling; Formless Curb and Gutter Machine; Grader, Elevating; Grouting Machines;

Heavy Duty Self-Propelled Transporter or Prime Mover; Highlift Shovels or Front Endloader 2-1/4 yd. and over; Hoists, Elevators, outside type rack and pinion and similar machines; Hoists, One, Two and Three Drum; Hoists, Two Tugger One Floor; Hydraulic Backhoes; Hydraulic Boom Trucks; Hydro Vac (and similar equipment); Locomotives, All; Motor Patrol; Lubrication Technician; Manipulators; Pile Drivers and Skid Rig; Post Hole Digger; Pre-Stress Machine; Pump Cretes Dual Ram; Pump Cretes: Squeeze Cretes-Screw Type Pumps; Gypsum Bulker and Pump; Raised and Blind Hole Drill; Roto Mill Grinder; Scoops - Tractor Drawn; Slip-Form Paver; Straddle Buggies; Operation of Tie Back Machine; Tournapull; Tractor with Boom and Side Boom; Trenching Machines.

Class 2. Boilers; Broom, All Power Propelled; Bulldozers; Concrete Mixer (Two Bag and Over); Conveyor, Portable; Forklift Trucks; Highlift Shovels or Front Endloaders under 2-1/4 yd.; Hoists, Automatic; Hoists, Inside Elevators; Hoists, Sewer Dragging Machine; Hoists, Tugger Single Drum; Laser Screed; Rock Drill (Self-Propelled); Rock Drill (Truck Mounted); Rollers, All; Steam Generators; Tractors, All; Tractor Drawn Vibratory Roller; Winch Trucks with "A" Frame.

Class 3. Air Compressor; Combination Small Equipment Operator; Generators; Heaters, Mechanical; Hoists, Inside Elevators (remodeling or renovation work); Hydraulic Power Units (Pile Driving, Extracting, and Drilling); Pumps, over 3" (1 to 3 not to exceed a total of 300 ft.); Low Boys; Pumps, Well Points; Welding Machines (2 through 5); Winches, 4 Small Electric Drill Winches.

Class 4. Bobcats and/or other Skid Steer Loaders; Oilers; and Brick Forklift.

Class 5. Assistant Craft Foreman.

Class 6. Gradall.

Class 7. Mechanics; Welders.

OPERATING ENGINEERS - HIGHWAY CONSTRUCTION

Class 1. Asphalt Plant; Asphalt Heater and Planer Combination; Asphalt Heater Scarfire; Asphalt Spreader; Autograder/GOMACO or other similar type machines; ABG Paver; Backhoes with Caisson Attachment; Ballast Regulator; Belt Loader; Caisson Rigs; Car Dumper; Central Redi-Mix Plant; Combination Backhoe Front Endloader Machine, (1 cu. yd. Backhoe Bucket or over or with attachments); Concrete Breaker (Truck Mounted); Concrete Conveyor; Concrete Paver over 27E cu. ft.; Concrete Placer; Concrete Tube Float; Cranes, all attachments; Cranes, Tower Cranes of all types; Creter Crane; Spider Crane; Crusher, Stone, etc.; Derricks, All; Derrick Boats; Derricks, Traveling; Dredges; Elevators, Outside type Rack & Pinion and Similar Machines; Formless Curb and Gutter Machine; Grader, Elevating; Grader, Motor Grader, Motor Patrol, Auto Patrol, Form Grader, Pull Grader, Subgrader; Guard Rail Post Driver Truck Mounted; Hoists, One, Two and Three Drum; Heavy Duty Self-Propelled Transporter or Prime Mover; Hydraulic Backhoes; Backhoes with shear attachments up to 40' of boom reach; Lubrication Technician; Manipulators; Mucking Machine; Pile Drivers and Skid Rig; Pre-Stress Machine; Pump Cretes Dual Ram; Rock Drill - Crawler or Skid Rig; Rock Drill - Truck Mounted; Rock/Track Tamper; Roto Mill Grinder; Slip-Form Paver; Snow Melters; Soil Test Drill Rig (Truck Mounted); Straddle Buggies; Hydraulic Telescoping Form (Tunnel); Operation of Tieback Machine; Tractor Drawn Belt Loader; Tractor Drawn Belt Loader (with attached pusher - two engineers); Tractor with Boom; Tractaire with Attachments; Traffic Barrier Transfer Machine; Trenching; Truck Mounted Concrete Pump with Boom; Raised or Blind Hole Drills (Tunnel Shaft); Underground Boring and/or Mining Machines 5 ft. in diameter and over tunnel, etc; Underground Boring and/or Mining Machines under 5 ft. in diameter; Wheel Excavator; Widener (APSCO).

Class 2. Batch Plant; Bituminous Mixer; Boiler and Throttle Valve; Bulldozers; Car Loader Trailing Conveyors; Combination Backhoe Front Endloader Machine (Less than 1 cu. yd. Backhoe Bucket or over or with attachments); Compressor and Throttle Valve; Compressor, Common Receiver (3); Concrete Breaker or Hydro Hammer; Concrete Grinding Machine; Concrete Mixer or Paver 7S Series to and including 27 cu. ft.; Concrete Spreader; Concrete Curing Machine, Burlap Machine, Belting Machine and Sealing Machine; Concrete Wheel Saw; Conveyor Muck Cars (Haglund or Similar Type); Drills, All; Finishing Machine - Concrete; Highlift Shovels or Front Endloader; Hoist - Sewer Dragging Machine; Hydraulic Boom Trucks (All Attachments); Hydro-Blaster; Hydro

BID

NOT FOR

Excavating (excluding hose work); Laser Screed; All Locomotives, Dinky; Off-Road Hauling Units (including articulating) Non Self-Loading Ejection Dump; Pump Cretes: Squeeze Cretes - Screw Type Pumps, Gypsum Bulker and Pump; Roller, Asphalt; Rotary Snow Plows; Rototiller, Seaman, etc., self-propelled; Self-Propelled Compactor; Spreader - Chip - Stone, etc.; Scraper - Single/Twin Engine/Push and Pull; Scraper - Prime Mover in Tandem (Regardless of Size); Tractors pulling attachments, Sheeps Foot, Disc, Compactor, etc.; Tug Boats.

Class 3. Boilers; Brooms, All Power Propelled; Cement Supply Tender; Compressor, Common Receiver (2); Concrete Mixer (Two Bag and Over); Conveyor, Portable; Farm-Type Tractors Used for Mowing, Seeding, etc.; Forklift Trucks; Grouting Machine; Hoists, Automatic; Hoists, All Elevators; Hoists, Tugger Single Drum; Jeep Diggers; Low Boys; Pipe Jacking Machines; Post-Hole Digger; Power Saw, Concrete Power Driven; Pug Mills; Rollers, other than Asphalt; Seed and Straw Blower; Steam Generators; Stump Machine; Winch Trucks with "A" Frame; Work Boats; Tamper-Form-Motor Driven.

Class 4. Air Compressor; Combination - Small Equipment Operator; Directional Boring Machine; Generators; Heaters, Mechanical; Hydraulic Power Unit (Pile Driving, Extracting, or Drilling); Light Plants, All (1 through 5); Pumps, over 3" (1 to 3 not to exceed a total of 300 ft.); Pumps, Well Points; Vacuum Trucks (excluding hose work); Welding Machines (2 through 5); Winches, 4 Small Electric Drill Winches.

Class 5. SkidSteer Loader (all); Brick Forklifts; Oilers.

Class 6. Field Mechanics and Field Welders

Class 7. Dowell Machine with Air Compressor; Gradall and machines of like nature.

OPERATING ENGINEER - FLOATING

Diver. Diver Wet Tender, Diver Tender, ROV Pilot, ROV Tender

TRUCK DRIVER - BUILDING, HEAVY AND HIGHWAY CONSTRUCTION

Class 1. Two or three Axle Trucks. A-frame Truck when used for transportation purposes; Air Compressors and Welding Machines, including those pulled by cars, pick-up trucks and tractors; Ambulances; Batch Gate Lockers; Batch Hopperman; Car and Truck Washers; Carry-alls; Fork Lifts and Hoisters; Helper; Mechanics Helpers and Greasers; Oil Distributors 2-man operation; Pavement Breakers; Pole Trailer, up to 40 feet; Power Mower Tractors; Self-propelled Chip Spreader; Skipman; Slurry Trucks, 2-man operation; Slurry Truck Conveyor Operation, 2 or 3 man; Teamsters; Unskilled Dumpman; and Truck Drivers hauling warning lights, barricades, and portable toilets on the job site.

Class 2. Four axle trucks; Dump Crets and Adgetors under 7 yards; Dumpsters, Track Trucks, Euclids, Hug Bottom Dump Turnapulls or Turnatrailers when pulling other than self-loading equipment or similar equipment under 16 cubic yards; Mixer Trucks under 7 yards; Ready-mix Plant Hopper Operator, and Winch Trucks, 2 Axles.

Class 3. Five axle trucks; Dump Crets and Adgetors 7 yards and over; Dumpsters, Track Trucks, Euclids, Hug Bottom Dump Turnatrailers or turnapulls when pulling other than self-loading equipment or similar equipment over 16 cubic yards; Explosives and/or Fission Material Trucks; Mixer Trucks 7 yards or over; Mobile Cranes while in transit; Oil Distributors, 1-man operation; Pole Trailer, over 40 feet; Pole and Expandable Trailers hauling material over 50 feet long; Slurry trucks, 1-man operation; Winch trucks, 3 axles or more; Mechanic--Truck Welder and Truck Painter.

Class 4. Six axle trucks; Dual-purpose vehicles, such as mounted crane trucks with hoist and accessories; Foreman; Master Mechanic; Self-loading equipment like P.B. and trucks with scoops on the front.

TERRAZZO FINISHER

The handling of sand, cement, marble chips, and all other materials that may be used by the Mosaic Terrazzo Mechanic, and the

mixing, grinding, grouting, cleaning and sealing of all Marble, Mosaic, and Terrazzo work, floors, base, stairs, and wainscoting by hand or machine, and in addition, assisting and aiding Marble, Masonic, and Terrazzo Mechanics.

Other Classifications of Work:

For definitions of classifications not otherwise set out, the Department generally has on file such definitions which are available. If a task to be performed is not subject to one of the classifications of pay set out, the Department will upon being contacted state which neighboring county has such a classification and provide such rate, such rate being deemed to exist by reference in this document. If no neighboring county rate applies to the task, the Department shall undertake a special determination, such special determination being then deemed to have existed under this determination. If a project requires these, or any classification not listed, please contact IDOL at 217-782-1710 for wage rates or clarifications.

LANDSCAPING

Landscaping work falls under the existing classifications for laborer, operating engineer and truck driver. The work performed by landscape plantsman and landscape laborer is covered by the existing classification of laborer. The work performed by landscape operators (regardless of equipment used or its size) is covered by the classifications of operating engineer. The work performed by landscape truck drivers (regardless of size of truck driven) is covered by the classifications of truck driver.

MATERIAL TESTER & MATERIAL TESTER/INSPECTOR I AND II

Notwithstanding the difference in the classification title, the classification entitled "Material Tester I" involves the same job duties as the classification entitled "Material Tester/Inspector I". Likewise, the classification entitled "Material Tester II" involves the same job duties as the classification entitled "Material Tester/Inspector II".

NOT FOR BID

**COMMUNITY RECREATION BUILDING DEMOLITION
VILLAGE OF VILLA PARK**

APPENDIX B

VILLAGE OF VILLA PARK BIDDER REQUIREMENTS ORDINANCE

NOT FOR BID

NOT FOR BID

AN ORDINANCE OF THE VILLAGE OF VILLA PARK, DUPAGE COUNTY, ILLINOIS AMENDING THE REQUIREMENTS OF BIDDERS FOR CONSTRUCTION PROJECTS

WHEREAS, the Village of Villa Park (the “*Village*”) is a duly organized and validly existing non home-rule municipality created in accordance with the Constitution of the State of Illinois of 1970 and the laws of the State; and,

WHEREAS, section 8-9-1 of the Illinois Municipal Code (65 ILCS 5/8-9-2) allows the Village to require competitive bidding after advertising for bids in the manner prescribed by ordinance; and,

WHEREAS, the President and Board of Trustees desire to adopt purchasing procedures to provide for additional requirements of bidders for construction projects to have active apprenticeship and training programs approved and registered with the United States Department of Labor’s Bureau of Apprenticeship and Training and to have bidders show three similar projects they constructed within the last five years.

NOW, THEREFORE, BE IT ORDAINED by the President and Board of Trustees of the Village of Villa Park, DuPage County, Illinois, as follows:

Section 1. That Section 2-219 of the Villa Park Municipal Code, as amended, be and is hereby amended by placing the existing text as subsection A. and adding a new subsection B. to read as follows:

“B. A responsible bidder for the construction of public works projects shall meet and submit evidence of compliance with the following requirements:

- (1) All applicable laws prerequisite to doing business in the State of Illinois,
- (2) A federal employer tax identification number or social security number,
- (3) Provision of Section 2000(e) of Chapter 21, Title 42 of the United States Code and Federal Executive Order No. 11246 as amended by Executive Order No. 11375 (known as the Equal Opportunity Employer provisions),
- (4) Certificates of insurance indicating the following coverage’s: general liability, worker’s compensation, completed operations, automobile, hazardous occupation and product liability
- (5) Compliance with all provisions of the Illinois Prevailing Wage Act, including wages, medical and hospitalization insurance and retirement for those trades covered in the Act,
- (6) The bidder and all bidder’s sub-contractors must participate in active apprenticeship and training programs approved and registered with the United States Department of Labor’s Bureau of Apprenticeship and Training for each of the trades of work contemplated under the proposed contract,
- (7) All contractors and sub-contractors are required to file certified payrolls as specified in Illinois Public Act 94-0515, and follow all provisions of the Employee Classification Act (820 ILCS 185/1 et seq.), and

(8) All bidders must provide three (3) projects of a similar nature constructed in the immediate past five (5) years with the name, address and telephone number of the contact person having knowledge of the project along with three (3) references (name, address, and telephone number) with knowledge of the integrity and business practices of the bidder.”

Section 2. This Ordinance shall be in full force and effect upon its passage, approval, and publication as provided by law.

Passed this 11 day of February, 2013.

AYES: ALL

NAYS: Aiello Bulthuis

ABSENT: _____

Approved this 11 day of February, 2013.

Village President

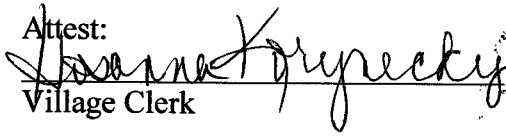
Attest:

Village Clerk



Published in pamphlet form:
2-11, 2013

NOT FOR BIDDING

**COMMUNITY RECREATION BUILDING DEMOLITION
VILLAGE OF VILLA PARK**

APPENDIX C

IRMA CONTRACTUAL INSURANCE GUIDELINES

NOT FOR BID

NOT FOR BID

- B. Owners and Contractors Protective Liability (OCP): \$1,000,000 combined single limit per occurrence for bodily injury and property damage.
- C. Business Automobile Liability: \$1,000,000 combined single limit per accident for bodily injury and property damage.
- D. Workers' Compensation and Employers' Liability: Workers' Compensation coverage with statutory limits and Employers' Liability limits of \$500,000 per accident.
- E. Builder's Risk: Shall insure against "All Risk" of physical damage, including water damage (flood and hydrostatic pressure not excluded), on a completed replacement cost basis.
- F. Environmental Impairment/Pollution Liability: \$1,000,000 combined single limit per occurrence for bodily injury, property damage and remediation costs.

-
-
-

Deductibles and Self-Insured Retentions

Any deductibles or self-insured retentions must be declared to and approved by the member. At the option of the member, either: the insurer shall reduce or eliminate such deductibles or self-insured retentions as respects the member, its officials, employees, agents and volunteers; or the Contractor shall procure a bond guaranteeing payment of losses and related investigation, claim administration and defense expenses.

Reporting Requirements

The policies are to contain, or be endorsed to contain, the following provisions:

Contractor's Insurance Coverage

1. The member, its officials, agents, employees and volunteers are to be covered as additional insureds as respects: liability arising out of the Contractor's work, including activities performed by or on behalf of the Contractor; products and completed operations of the Contractor; premises owned, leased or used by the Contractor; or automobiles owned, leased, hired or borrowed by the Contractor. The coverage shall contain no special limitations on the scope of protection afforded to the member, its officials, agents, employees and volunteers.
2. The Contractor's insurance coverage shall be primary as respects the member, its officials, employees, agents and volunteers. Any insurance or self-insurance maintained by the member, its officials, agents, employees and volunteers shall be excess of Contractor's insurance and shall not contribute with it.
3. Any failure to comply with reporting provisions of the policies shall not affect coverage provided to the member, its officials, employees, agents and volunteers.
4. The Contractor's insurance shall contain a Severability of Interests/Cross Liability clause or language stating that Contractor's insurance shall apply separately to each insured against whom claim is made or suit is brought, except with respect to the limits of the insurer's liability.
5. If any commercial general liability insurance is being provided under an excess

Each insurance policy required shall have the member expressly endorsed onto the policy as a Cancellation Notice Recipient. Should any of the policies be cancelled before the expiration date thereof, notice will be delivered in accordance with the policy provisions.

 I R

Insurance is to be placed with insurers with a Best's rating of no less than A-, VII and licensed to do business in the State of Illinois.

 RI R

Contractor shall furnish the member with certificates of insurance naming the member, its officials, employees, agents and volunteers as additional insureds (Exhibit D), and with original endorsements affecting coverage required by this clause. The certificates and endorsements for each insurance policy are to be signed by a person authorized by that insurer to bind coverage on its behalf. The certificates and endorsements are to be received and approved by the member before any work commences. The following additional insured endorsements may be utilized: ISO Additional Insured Endorsements CG 2010 (Exhibit A) or CG 2026 (Exhibit B), and CG 2037 (Exhibit C) – Completed Operations, where required. The member reserves the right to request full certified copies of the insurance policies and endorsements.

 R R

Contractor shall include all subcontractors as insureds under its policies or shall furnish separate certificates and endorsements for each subcontractor. All coverages for subcontractors shall be subject to all of the requirements stated herein.

 M I I

The contractor assumes liability for all injury to or death of any person or persons including employees of the contractor, any sub-contractor, any supplier or any other person and assumes liability for all damage to property sustained by any person or persons occasioned by or in any way arising out of any work performed pursuant to this agreement.

 D M D RM R I I

To the fullest extent permitted by law, the Contractor hereby agrees to defend, indemnify and hold harmless the member, its officials, employees and agents against all injuries, deaths, loss, damages, claims, patent claims, suits, liabilities, judgments, cost and expenses, which may in anywise accrue against the member, its officials, agents and employees, arising in whole or in part or in consequence of the performance of this work by the Contractor, its employees, or subcontractors, or which may in anywise result therefore, except that arising out of the sole legal cause of the member, its employees or agents, the Contractor shall, at its own expense, appear, defend and pay all charges of attorneys and all costs and other expenses arising therefore or incurred in connections therewith, and, if any judgment shall be rendered against the member, its officials, employees and agents, in any such action, the Contractor shall, at its own expense, satisfy and discharge the same.

Contractor expressly understands and agrees that any performance bond or insurance policies required by this contract, or otherwise provided by the Contractor, shall in no way limit the responsibility to indemnify, keep and save harmless and defend the member, its

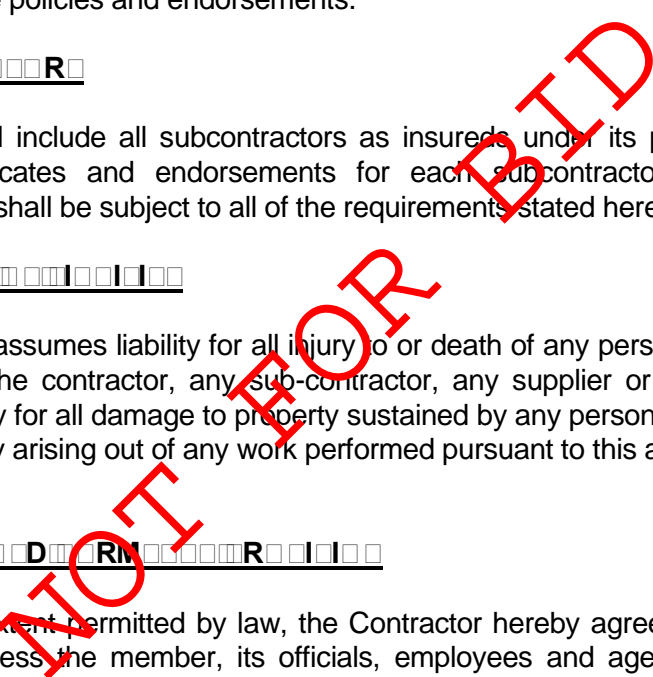

officials, employees and agents as herein provided.

The Contractor further agrees that to the extent that money is due the Contractor by virtue of this contract as shall be considered necessary in the judgment of the member, may be retained by the member to protect itself against said loss until such claims, suits, or judgments shall have been settled or discharged and/or evidence to that effect shall have been furnished to the satisfaction of the member.

□
III □

□□□□□□□□□□R□□□□□□□□□□

□□□□□□□□□□r□□□□□□□□□□r□r□□R□□r□□□□□□

- Successful bidder will provide written confirmation that a safety/loss prevention program was in place at least 90 days prior to submitting the bid proposal.
- Evidence of completed employee safety training can be provided.

R□□□□□□r□R□□□r□□□□□□

- Successful bidder must comply with all applicable laws, regulations, and rules promulgated by any Federal, State, County, Municipal and/or other governmental unit or regulatory body now in effect or which may be in effect during the performance of the work. Included within the scope of the laws, regulations, and rules referred to in this paragraph but in no way to operate as a limitation, are Occupational Safety & Health Act (OSHA), Illinois Department of Labor (IDOL), Department of Transportation, all forms of traffic regulations, public utility, Intrastate and Interstate Commerce Commission regulations, Workers' Compensation Laws, Prevailing Wage Laws, the Social Security Act of the Federal Government, and any of its titles, the Illinois Department of Human Rights, Human Rights Commission, or EEOC statutory provisions and rules and regulations.
- Evidence of specific regulatory compliance will be provided by bidder, if required by owner.

NOT FOR BID

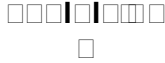

POLICY NUMBER:

COMMERCIAL GENERAL LIABILITY
CG 20 10 07 04

THIS ENDORSEMENT CHANGES THE POLICY. PLEASE READ IT CAREFULLY.

**ADDITIONAL INSURED – OWNERS, LESSEES OR
CONTRACTORS – SCHEDULED PERSON OR
ORGANIZATION**

This endorsement modifies insurance provided under the following:

COMMERCIAL GENERAL LIABILITY COVERAGE PART

SCHEDULE

| Name Of Additional Insured Person(s) Or Organization(s): | Location(s) Of Covered Operations |
|--|-----------------------------------|
| | |
| Information required to complete this Schedule, if not shown above, will be shown in the Declarations. | |

A. Section II – Who Is An Insured is amended to include as an additional insured the person(s) or organization(s) shown in the Schedule, but only with respect to liability for "bodily injury", "property damage" or "personal and advertising injury" caused, in whole or in part, by:

1. Your acts or omissions; or
2. The acts or omissions of those acting on your behalf;

in the performance of your ongoing operations for the additional insured(s) at the location(s) designated above.

B. With respect to the insurance afforded to these additional insureds, the following additional exclusions apply:

This insurance does not apply to "bodily injury" or "property damage" occurring after:

1. All work, including materials, parts or equipment furnished in connection with such work, on the project (other than service, maintenance or repairs) to be performed by or on behalf of the additional insured(s) at the location of the covered operations has been completed; or
2. That portion of "your work" out of which the injury or damage arises has been put to its intended use by any person or organization other than another contractor or subcontractor engaged in performing operations for a principal as a part of the same project.

NOT FOR SAMPLE BID

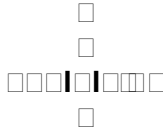

POLICY NUMBER:

COMMERCIAL GENERAL LIABILITY
CG 20 26 07 04

THIS ENDORSEMENT CHANGES THE POLICY. PLEASE READ IT CAREFULLY.

**ADDITIONAL INSURED – DESIGNATED
PERSON OR ORGANIZATION**

This endorsement modifies insurance provided under the following:

COMMERCIAL GENERAL LIABILITY COVERAGE PART

SCHEDULE

| Name Of Additional Insured Person(s) Or Organization(s) |
|--|
| <p style="text-align: center; color: red; font-size: 2em; opacity: 0.5;">NOT FOR BID</p> |
| Information required to complete this Schedule, if not shown above, will be shown in the Declarations. |

Section II – Who Is An Insured is amended to include as an additional insured the person(s) or organization(s) shown in the Schedule, but only with respect to liability for "bodily injury", "property damage" or "personal and advertising injury" caused, in whole or in part, by your acts or omissions or the acts or omissions of those acting on your behalf:

- A. In the performance of your ongoing operations; or
- B. In connection with your premises owned by or rented to you.





POLICY NUMBER:

COMMERCIAL GENERAL LIABILITY
CG 20 37 07 04

THIS ENDORSEMENT CHANGES THE POLICY. PLEASE READ IT CAREFULLY.

**ADDITIONAL INSURED – OWNERS, LESSEES OR
CONTRACTORS – COMPLETED OPERATIONS**

This endorsement modifies insurance provided under the following:

COMMERCIAL GENERAL LIABILITY COVERAGE PART

SCHEDULE

| Name Of Additional Insured Person(s) Or Organization(s): | Location And Description Of Completed Operations |
|--|--|
| | |
| Information required to complete this Schedule, if not shown above, will be shown in the Declarations. | |

Section II – Who Is An Insured is amended to include as an additional insured the person(s) or organization(s) shown in the Schedule, but only with respect to liability for "bodily injury" or "property damage" caused, in whole or in part, by "your work" at the location designated and described in the schedule of this endorsement performed for that additional insured and included in the "products-completed operations hazard".

NOT FOR SAMPLE BID



**COMMUNITY RECREATION BUILDING DEMOLITION
VILLAGE OF VILLA PARK**

APPENDIX D

LOCATION MAPS

NOT FOR BID

NOT FOR BID



**Village of Villa Park
Community Recreation Building Demolition
2023 Project Area**

 Project Area

The enclosed materials and documentation are being provided pursuant to a request for information, which has been submitted, to the Village of Villa Park, Illinois. The Village expressly disclaims any responsibility for the accuracy of completeness of the materials and documentation provided, and any use thereof is at the requestor's sole and exclusive risk and expense.



Map Created by Brian Roche

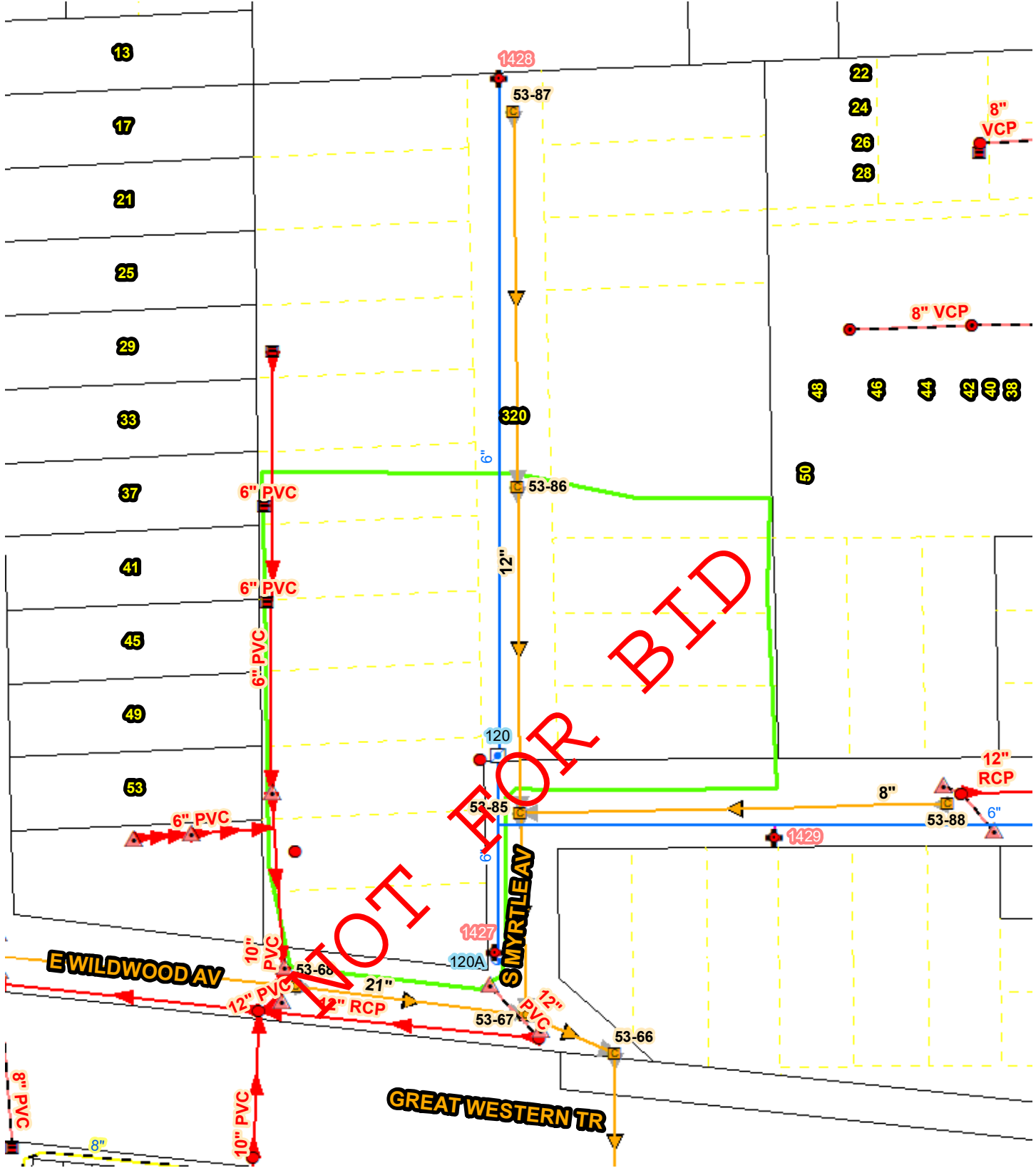

NOT FOR BID

**Village of Villa Park
Community Recreation Building Demolition
2023 Project Area**

Project Area

The enclosed materials and documentation are being provided pursuant to a request for information, which has been submitted, to the Village of Villa Park, Illinois. The Village expressly disclaims any responsibility for the accuracy of completeness of the materials and documentation provided, and any use thereof is at the requestor's sole and exclusive risk and expense.

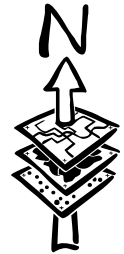

Map Created by Brian Roche

REPORTS

Provided Digitally on the Village Website at <https://www.invillapark.com/699/Open-Bids>

Geotechnical Investigation
Geotechnical CCDD Report
Asbestos Survey Report
Lead Survey Report
Air Quality Sampling Professional Report

NOT FOR BID